

IMPORTANT SAFETY INSTRUCTIONS

HOUSEHOLD USE ONLY

⚠ WARNING

TO REDUCE THE RISK OF FIRE, ELECTRIC SHOCK, OR INJURY:

READ ALL THESE INSTRUCTIONS BEFORE USE.

1. This appliance has a polarized plug (one blade is wider than the other). To reduce the risk of electric shock, this plug is intended to fit in a polarized outlet only one way. If the plug does not fit fully in the outlet, reverse the plug. If it still does not fit, contact a qualified electrician. Do not attempt to defeat this safety feature. Unplug or disconnect the appliance from the power supply before servicing.
2. **DO NOT** operate any unit with a damaged cord or plug. Discard the unit or return to an authorized service facility for examination and/or repair.
3. **DO NOT** run cord under carpeting. **DO NOT** cover cord with throw rugs, runners, or similar coverings. **DO NOT** route cord under furniture or appliances. Keep cord away from high traffic areas where it will not be tripped over.
4. If the power cord is damaged, it must be replaced by the manufacturer, its service agent, or similarly qualified persons in order to avoid a hazard.
5. This appliance is not intended for use by anyone (including children) with reduced physical, sensory or mental capabilities, or lack of experience and knowledge, unless they have been given supervision or instruction concerning use of the appliance by a person responsible for their safety.
6. Children should be supervised to ensure that they **DO NOT** play with the appliance.
7. Cleaning and user maintenance shall not be made by children without supervision.
8. Prior to cleaning or other maintenance, the appliance must be unplugged from the electrical outlet.
9. **DO NOT** handle plug or appliance with wet hands.
10. **DO NOT** use without filter in place.
11. Only use Shark® branded filters and accessories.
12. **DO NOT** damage the power cord:
 - a) **DO NOT** pull or carry appliance by the cord or use the cord as a handle.
 - b) **DO NOT** unplug by pulling on cord. Grasp the plug, not the cord.
 - c) **DO NOT** stand the appliance on the power cord, close a door on the cord, pull the cord around sharp corners, or leave the cord near heated surfaces.
13. **DO NOT** use with any opening blocked; keep free of dust, lint, hair, and anything that may reduce airflow.
14. **DO NOT** use if airflow is restricted. If the air paths become blocked, turn the appliance off and unplug from electrical outlet. Remove all obstructions before you plug in and turn on the unit again.
15. **DO NOT** use if appliance is not working as it should, or has been dropped, damaged, left outdoors, or dropped into water.
16. **DO NOT** place appliance on unstable surfaces such as chairs or tables.
17. **DO NOT** use in the following areas:
 - a) Wet or damp surfaces
 - b) Outdoor areas
 - c) Spaces that are enclosed and may contain explosive or toxic fumes or vapors (lighter fluid, gasoline, kerosene, paint, paint thinners, mothproofing substances, or flammable dust)
18. Turn off all controls before plugging in or unplugging the appliance.
19. Unplug from electrical outlet when not in use and before any maintenance or cleaning.
20. Hand-wash with water only. Washing with cleaning chemicals could damage the unit.
21. Make sure filter is in place after routine maintenance.
22. Not suitable for use with solid-state speed controls.

REMOTE BATTERY

23. Dispose of batteries properly. Keep batteries away from children at all times. Even used batteries can cause injury.

⚠ WARNING: Chemical Burn Hazard. Keep batteries away from children.

This product contains a lithium button/coin cell battery. If a new or used lithium button/coin cell battery is swallowed or enters the body, it can cause severe internal burns and can lead to death in as little as 2 hours. When not changing batteries, keep the battery compartment completely closed. If the battery compartment does not close securely, stop using the product, remove the batteries, and keep them away from children. If you think batteries might have been swallowed or placed inside any part of the body, seek immediate medical attention.

READ AND SAVE THESE INSTRUCTIONS

visit qr.sharkclean.com/hp200series or

SCAN HERE

USING YOUR SMARTPHONE CAMERA

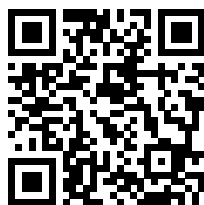

FOR FULL INSTRUCTIONS, TO PURCHASE ACCESSORIES, OR TO REPLACE FILTERS.



Remove Enclosed Filter From Packaging Before Operating

Please be sure to read and save the warnings on other side prior to using your unit.

QUICK START GUIDE

Your Shark® HP200 Series Air Purifier removes allergens, mold, bacteria, and other particles from your air for a cleaner home.

SETTING UP YOUR UNIT



1. First, carefully flip the air purifier upside down and place it on a level surface. Twist the filter door to unlock the filter.



2. Take the filter out of its packaging, then insert it back into the unit. **DO NOT** run the air purifier unless the filter is removed from its packaging and properly reinstalled.

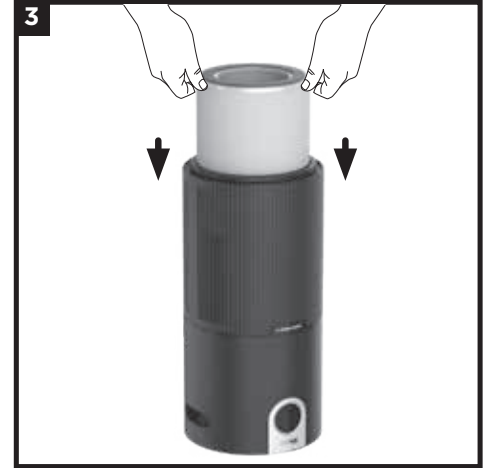

3. With the filter reinstalled, twist the filter door until it clicks into place.

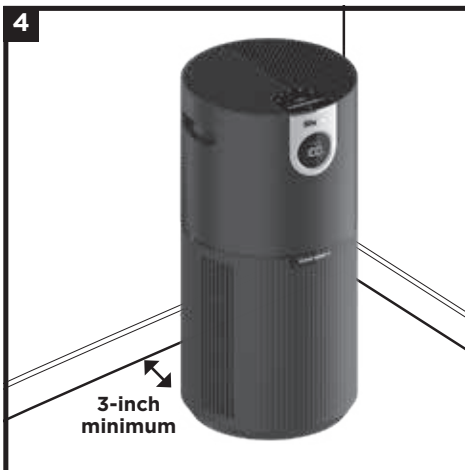

4. Set up the unit on a level surface, at least 3 inches (8-cm) away from walls and objects.

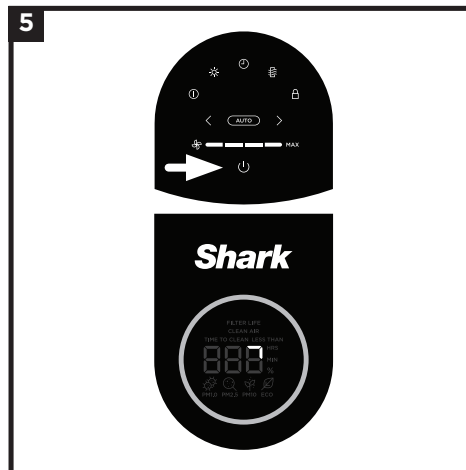

5. Plug the unit into an electrical outlet and press the power button on the top control panel. When the unit is powered on, it will begin to analyze the air quality indicated by the rotating lights. After a few seconds the unit will display the current air quality.

visit qr.sharkclean.com/hp200series or
SCAN HERE
USING YOUR SMARTPHONE CAMERA



FOR FULL INSTRUCTIONS,
TO PURCHASE ACCESSORIES,
OR TO REPLACE FILTERS.

RECOMMENDATIONS

TRY THESE TIPS TO ENSURE CLEAN AIR CONFIDENCE.

- **Run on Auto Mode**—it'll adjust fan speeds automatically. As air quality decreases, the fan speed will increase. After 100% clean air status is achieved for 10 minutes in Auto Mode, your air purifier will enter Eco Mode. If particles are detected, your fan will turn back on.
- **Don't wash filters**—they're designed to perform optimally for 8-12 months on their own.

LOWER AIR QUALITY HAPPENS.

Potential causes:

- Cooking
- Burning food
- Dust
- Smoke
- Pollen
- Cleaning products

WANT TO MUTE YOUR AIR PURIFIER'S BEEPING?



To control your unit's beeping, hold the Air Info and Child Lock buttons at the same time for two seconds.