

Please be sure to read the enclosed Shark® Owner's Guide prior to using your unit.

# Shark® POWERED LIFT-AWAY® duo clean™

## QUICK START GUIDE

### WHAT'S INSIDE

- A Handle
- B Hose
- C Vacuum Pod
- D Wand
- E Motorized Floor Nozzle
- F 12" Crevice Tool
- G Upholstery Tool

### ASSEMBLY

1. Insert wand into floor nozzle.
2. Insert handle into wand.
3. Place pod onto wand. Slide down to connect.
4. Connect hose to back of pod, pressing until it clicks into place.

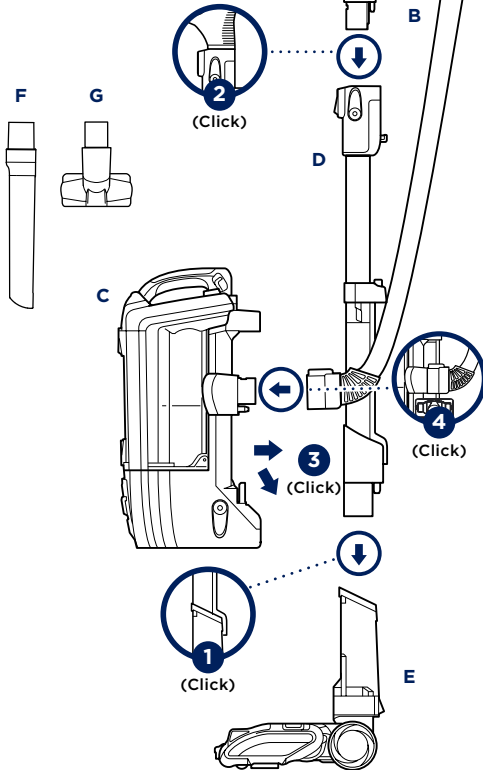

**NOTE:** For proper operation, ensure all parts are firmly **CLICKED** into place.

### EMPTYING THE DUST CUP

Empty the dust cup after each use.

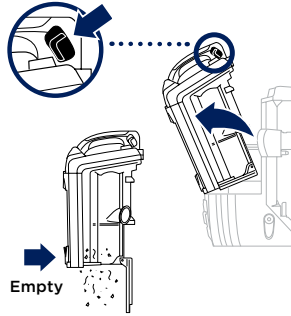

**Filter Maintenance**  
To keep suction strong, rinse filters regularly, using water only. Allow filters to air-dry completely before reinstalling. Tap loose dirt from foam filters as needed between washes. See enclosed Owner's Guide for complete details on removing and cleaning filters.

### EASY ACCESS TO YOUR BRUSHROLLS

Open the brushroll garage by sliding back the release buttons. To close, insert the tabs on the lid into the slots on the nozzle, then press down both sides. If the lid isn't completely closed, the headlights will flash.

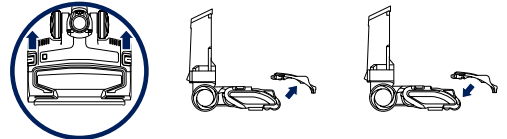

### BRUSHROLL MAINTENANCE

Remove any string, hair, or debris that may be wrapped around the brushroll by running scissors along the guide on the brushroll.

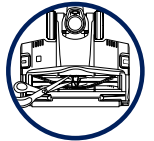

### SOFT ROLLER MAINTENANCE

Lift out the Soft Roller by pulling the tab on the right side. Clear away any debris, then slide the Soft Roller back into place.

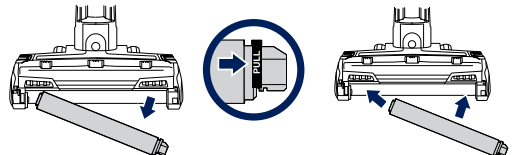

# VERSATILE FLOOR-TO-CEILING CLEANING

## UPRIGHT MODE

Place foot on floor nozzle and tilt handle back. Choose appropriate floor setting and press power button.

Power Button

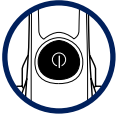

Floor Type

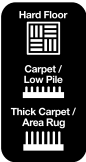
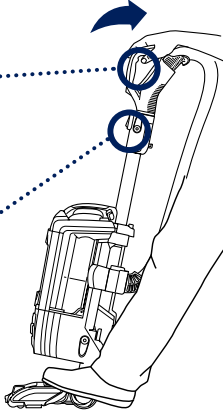

**Hard Floor:** Gentle on bare floors and delicate rugs.

**Carpet/Low Pile:** Optimized brushroll speed and suction for carpets.

**Thick Carpet/Area Rug:** Optimized brushroll speed and suction for thick carpets.

## POWERED LIFT-AWAY® MODE

Press Lift-Away Release button to lift pod off floor nozzle. You are now ready to clean those hard-to-reach places.



Lift-Away Release

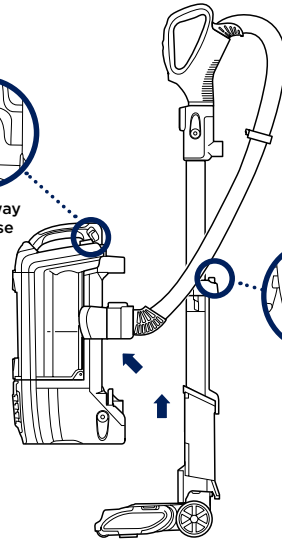

Wand Release

## ABOVE-FLOOR CLEANING IN LIFT-AWAY MODE

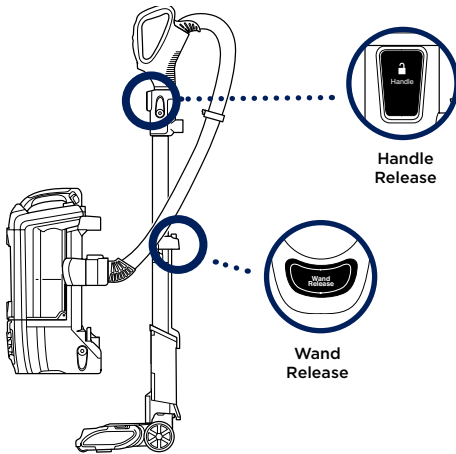

Handle Release



Wand Release

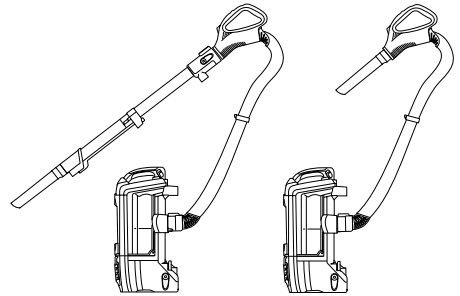

Attach any of the specialized cleaning accessories to the handle or wand.

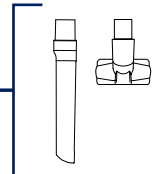

For additional parts and accessories, visit [sharkaccessories.com](http://sharkaccessories.com)

For questions or to register your product, visit us online at [sharkclean.com](http://sharkclean.com)

