

Please be sure to read the enclosed Shark® Owner's Guide prior to using your unit.

Shark® ROTATOR® PET PLUS

QUICK START GUIDE

WHAT'S INSIDE

- A Vacuum Pod
- B Handle & Hose
- C Wand
- D Hose Clip
- E 5.5" Crevice Tool
- F Pet Power Brush

ASSEMBLY

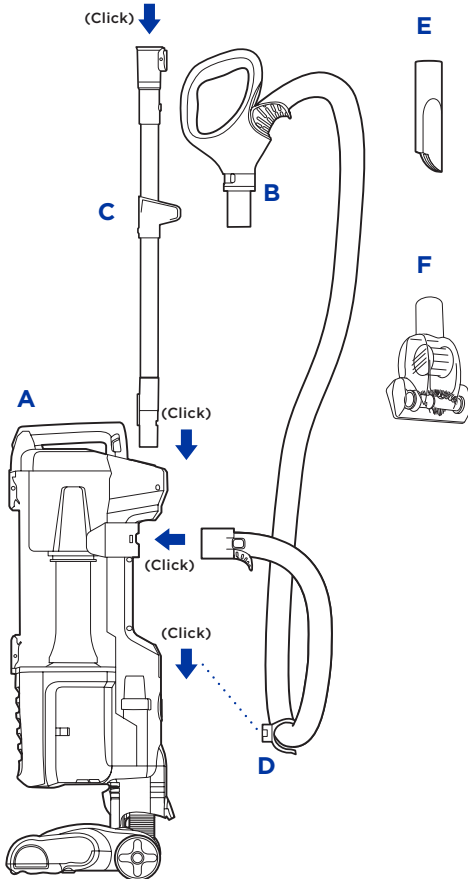

NOTE: For proper operation, ensure all parts are firmly **CLICKED** into place.

EMPTYING THE DUST CUP

Empty the dust cup after each use.

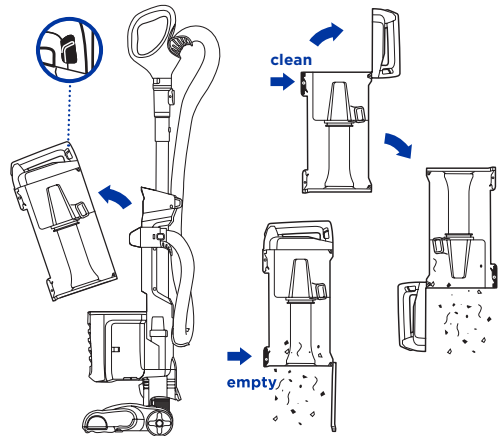

MAINTENANCE

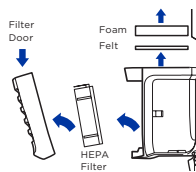

Remove dust cup to access foam and felt filters. Next, press down top of filter door and lift out. Press tab at top of HEPA filter and pull away from the base of the vacuum.

To reinstall, insert HEPA filter into unit and replace the filter door.

Wash filters every 3 months to keep the suction strong.

Rinse filters with water only and allow to air-dry completely. Tap loose dirt from foam filters as needed between washes.

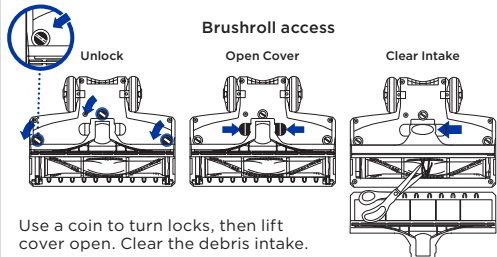

Use a coin to turn locks, then lift cover open. Clear the debris intake.

2 WAYS TO CLEAN

FLOOR CLEANING

SUCTION CONTROL

Adjust your suction depending on your floor type.

MIN: to reduce suction and increase maneuverability on carpets.

MAX: to increase suction on bare floors.

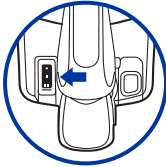

1

HARD FLOOR

Press switch to I for hard floor surfaces.

OR



2

CARPET

Press switch to II for low and high pile carpet cleaning.

3

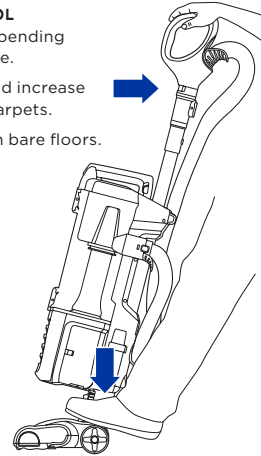

To engage brushroll, step on floor nozzle and tilt handle back.

ABOVE-FLOOR CLEANING

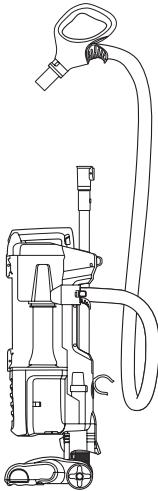

1

To clean above-floor areas, remove the handle from the wand. Or for the more reach, remove the wand from the pod.

OR

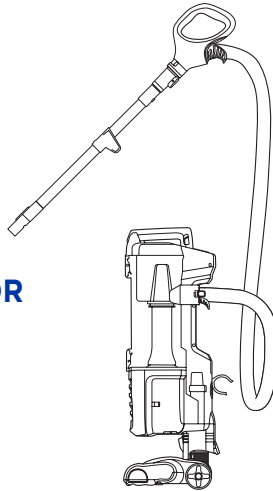

2

Attach desired cleaning accessory to handle or wand.

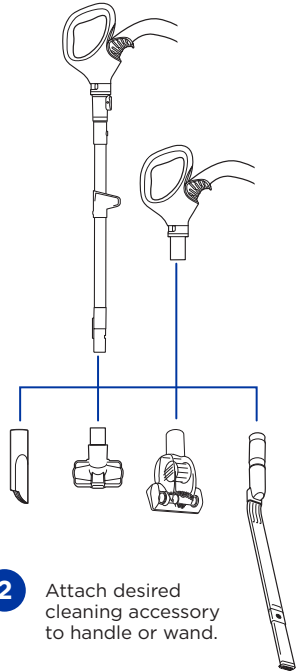

For additional parts and accessories, visit, sharkaccessories.com

For questions or to register your product, visit us online at sharkclean.com

