

Please be sure to read the enclosed Shark® Owner's Guide prior to using your unit.

# QUICK START GUIDE

## WHAT'S INSIDE

- A Handle & Hose
- B Motorized Floor Nozzle
- C Wand
- D Pet Multi-Tool
- E Crevice Tool
- F Anti-Allergen Dusting Brush
- G Li-Ion Charger
- H HEPA Post-Motor Filter (Pre-Installed)

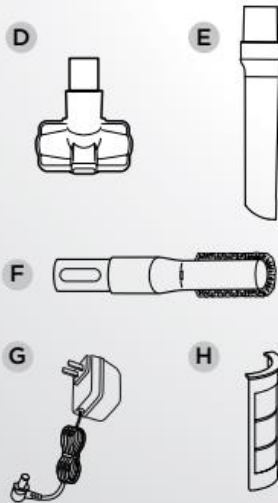

## ASSEMBLY

1. Insert the **Wand** into the **Floor Nozzle**.
2. Insert the **Handle** into the wand.
3. Align the bottom of the **Pod** onto the rails on the neck of the floor nozzle. Slide the pod down the rails until it clicks into place.
4. Connect the **Hose** to back of the pod, and attach the **Hose Clip** to the wand.
5. Charge the **Battery** completely before first use. With the handle toward the back, insert the battery into the slot in the pod until it clicks into place.

For proper operation, ensure all connections are securely clicked into place.



**NOTE:** The **Lithium-Ion Power Pack** battery comes partially charged. Charge fully before first use, then run the battery down until it is completely out of power. This will condition the battery so the LED indicators will work properly.

Full charge takes approximately 3.5 hours.

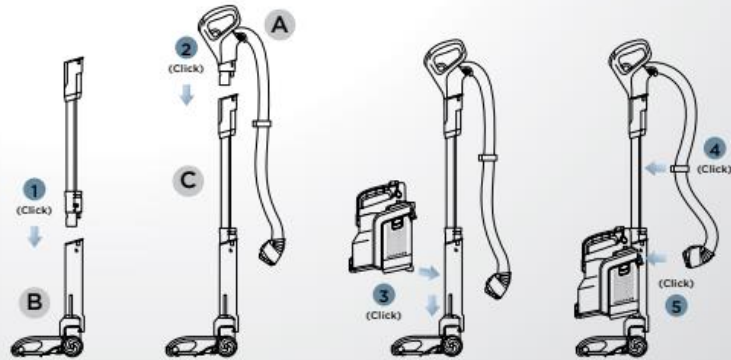

STANDARD BRUSHROLL

HAIR WRAP



THE VACUUM THAT DEEP-CLEANS  
**NOW CLEANS ITSELF™**

SELF-CLEANING BRUSHROLL

NO HAIR