

Shark[®] ***Rocket***[®]

UV422

Series

INSTRUCTIONS

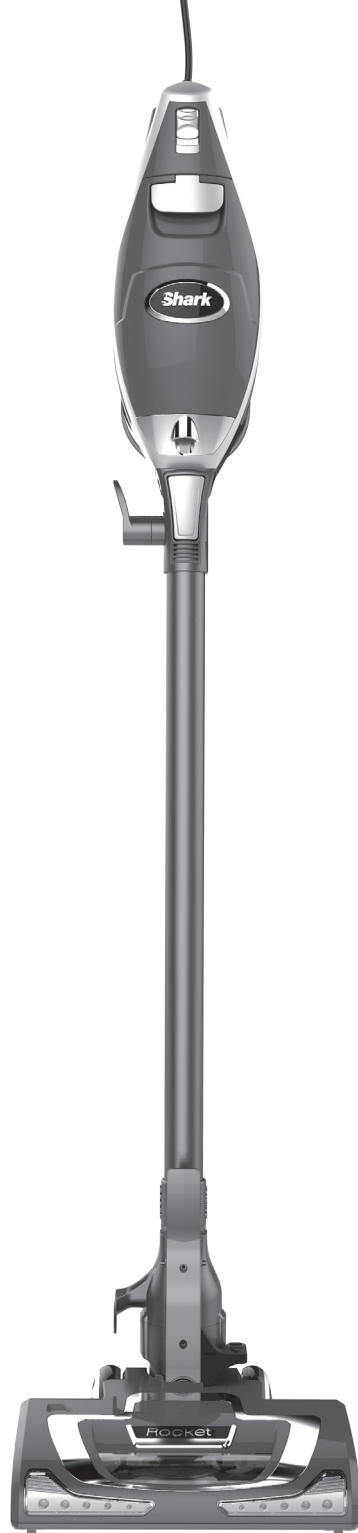

 sharkclean.com

 1-800-798-7398

THANK YOU

for purchasing the Shark® Rocket® Ultra-Light Upright

REGISTER YOUR PURCHASE

 sharkclean.com

 1-800-798-7398

 **TIP:** You can find the model number on the rating label which is located behind the dust cup.

 **TIP:** You can locate the date code on one of the prongs of the power cord plug.

RECORD THIS INFORMATION

Model Number: _____

Date Code: _____

Date of Purchase (Keep receipt): _____

Store of Purchase: _____

TECHNICAL SPECIFICATIONS

Voltage: 120V., 60Hz

Watts: 500W

Amps: 4.2A

PLEASE READ CAREFULLY AND KEEP FOR FUTURE REFERENCE.

This Owner's Guide is designed to help you get a complete understanding of your new Shark Rocket Ultra-Light Upright.

If you have any questions, please call the customer service line at 1-800-798-7398.

CONTENTS

Important Safety Instructions	3
Getting To Know Your Shark® Rocket® Ultra-Light Upright ..	5
Assembling Your Vacuum	7
Using the Motorized Floor Nozzle	9
Choosing the Appropriate Setting	10
Using the Dust-Away™ Hard Floor Attachment	11
Using Your Vacuum in Above-Floor Mode	12
Storage	13
Accessories	15
Maintaining Your Vacuum	17
Emptying the Dust Cup.....	17
Cleaning the Filters.....	18
Microfiber Pad Care	19
Checking for Blockages.....	19
Troubleshooting Guide	21
Warranty	22

IMPORTANT SAFETY INSTRUCTIONS

FOR HOUSEHOLD USE ONLY

⚠ WARNING

To reduce the risk of injury, fire, electric shock, and property damage resulting from improper use of the appliance, carefully observe the following instructions. This unit contains electrical connections and moving parts that potentially present risk to the user.

THE MOTORIZED FLOOR NOZZLE, WAND, AND HANDHELD VACUUM CONTAIN ELECTRICAL CONNECTIONS:

- These are not serviceable parts.
 - Do not use to vacuum any liquids.
 - Do not immerse in water when cleaning.
 - If handheld vacuum/wand is damaged, discontinue use.
-

- 1** Inspect power cord and plug for any damage before use. DO NOT use vacuum cleaner with a damaged cord or plug. Turn off all controls before plugging in or unplugging the vacuum cleaner. Store your vacuum cleaner with the power cord secured around the two cord hooks.
- 2** DO NOT use outdoors or on wet surfaces. Use only on dry surfaces.
- 3** Unplug from electrical outlet when not in use and before servicing.
- 4** If vacuum cleaner is not working as it should, or has been dropped, damaged, left outdoors, or dropped into water, return it to SharkNinja Operating LLC for examination, repair, or adjustment.
- 5** DO NOT pull or carry vacuum cleaner by the cord or use the cord as a handle.
- 6** DO NOT unplug by pulling on cord. Grasp the plug, not the cord.
- 7** DO NOT handle plug or vacuum cleaner with wet hands.

- 8** DO NOT run the vacuum cleaner over the power cord, close a door on the cord or pull the cord around sharp corners.
- 9** The use of an extension cord is NOT recommended.
- 10** DO NOT leave vacuum cleaner when plugged in.
- 11** Keep cord away from heated surfaces.

GENERAL USE

- 12** Use only as described in this manual.
- 13** Keep your work area well lit.
- 14** Keep the vacuum cleaner moving over the carpet surface at all times to avoid damaging the carpet fibers.
- 15** DO NOT place vacuum cleaner on unstable surfaces such as chairs or tables.
- 16** DO NOT put any objects into openings. DO NOT use with any opening blocked; keep free of dust, lint, hair, and anything that may reduce airflow.
- 17** DO NOT allow the appliance to be used by children. Close attention is necessary when used near children. This is not a toy.
- 18** DO NOT use without dust cup and/or filters in place.
- 19** DO NOT use if airflow is restricted. If the air paths or the motorized floor nozzle become blocked, turn the vacuum cleaner off and unplug from electrical outlet. Remove all obstructions before you turn on the unit again.

SAVE THESE INSTRUCTIONS

PLEASE READ CAREFULLY BEFORE USE

20 Keep nozzle away from hair, face, fingers, uncovered feet, or loose clothing.

21 Only use manufacturer's recommended attachments.

DUST CUP/FILTERS/ACCESSORIES

Before turning on the vacuum:

22 Make sure that all filters are thoroughly dry after routine cleaning.

23 Make sure that dust cup and all filters are in place after routine maintenance.

24 Make sure accessories are free of blockages and keep openings away from face and body.

25 Only use Shark®-brand filters and accessories (failure to do so will void the warranty).

GENERAL CLEANING

26 DO NOT vacuum up large objects.

27 DO NOT vacuum up hard or sharp objects such as glass, nails, screws, or coins that could damage the vacuum cleaner.

28 DO NOT vacuum up drywall dust, fireplace ash, or embers. DO NOT use as an attachment to power tools for dust collection.

30 DO NOT vacuum up smoking or burning objects such as hot coals, cigarette butts, or matches.

31 DO NOT vacuum up flammable or combustible materials (e.g., lighter fluid, gasoline, or kerosene) or use vacuum in areas where they may be present.

32 DO NOT vacuum up toxic solutions (e.g., chlorine bleach, ammonia, or drain cleaner).

33 DO NOT use in an enclosed space where vapors are present from paint, paint thinner, moth-proofing substances, flammable dust, or other explosive or toxic materials.

34 DO NOT vacuum up any liquids.

35 DO NOT immerse vacuum cleaner in water or other liquids.

36 Use extra care when cleaning on stairs.

.....

POLARIZED PLUG

To reduce the risk of electric shock, this vacuum cleaner has a polarized plug (one blade is wider than the other). As a safety feature, this plug will fit into a polarized outlet only one way. If the plug does not fit fully into the outlet, reverse the plug. If it still does not fit, contact a qualified electrician. DO NOT force into outlet or try to modify to fit.

GETTING TO KNOW YOUR SHARK® ROCKET® ULTRA-LIGHT UPRIGHT

WELCOME!

Congratulations on your purchase. Use this instruction manual to learn about your new vacuum's great features. From assembly to use to maintenance, you will find it all in here.

MAIN UNIT

- A** Power Switch
- B** Handheld Vacuum
- C** Dust Cup Release
- D** Handheld Vacuum Catch
- E** LED Light
- F** Cord Hooks (not visible)
- G** Wand Release
- H** Wand
- I** On-Board Tool Clip
- J** Handheld Vacuum Storage Hook
- K** Lower Wand Release Pedal
- L** Brushroll Indicator Light
- M** Motorized Floor Nozzle
- N** Headlights
- O** Wall Mount

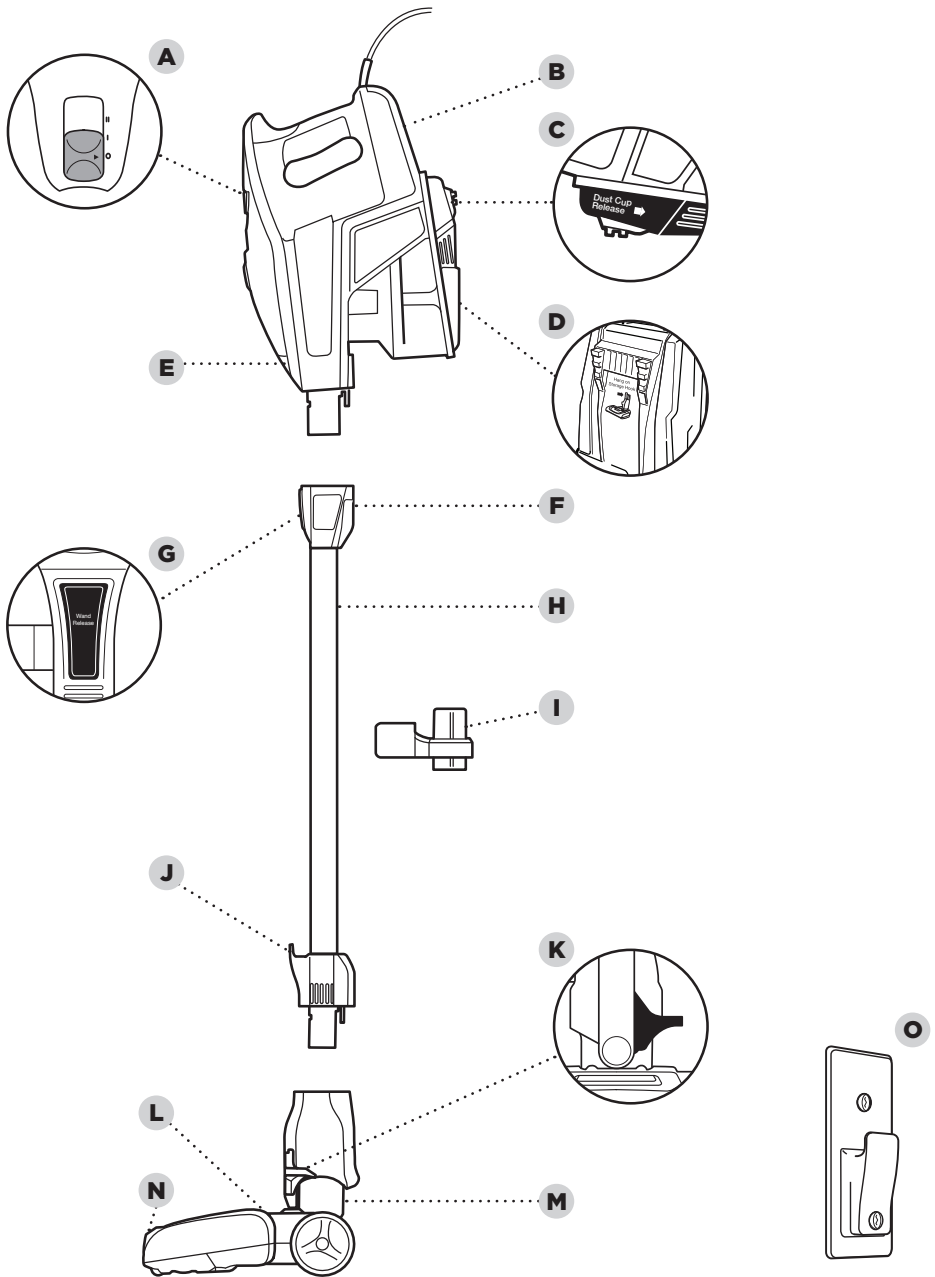

ASSEMBLING YOUR VACUUM

DID YOU KNOW?

The motorized floor nozzle and handheld vacuum have LED lights that illuminate the floor surface being cleaned. The lights turn on automatically in either speed setting.

STEP 1

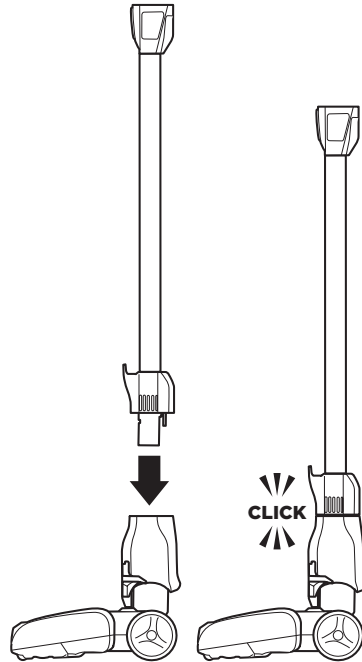

- 1** Insert the wand into the motorized floor nozzle connector until you hear a click.

STEP 2

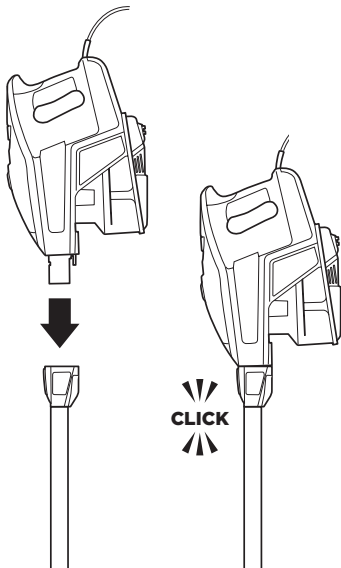

STEP 3

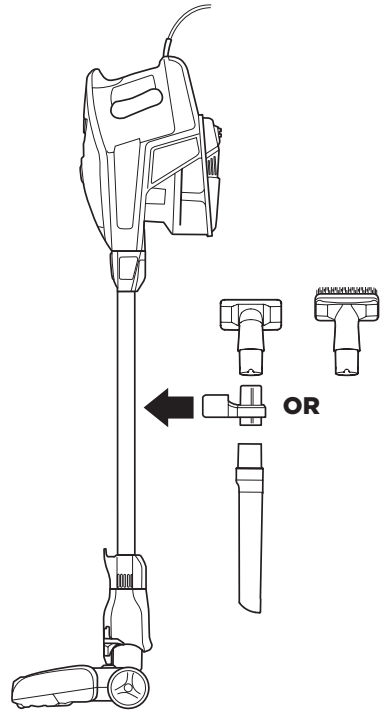

2 Insert the handheld vacuum into the top of the wand until you hear a click.

3 This vacuum comes with a detachable clip to store up to 2 accessories on board. Snap clip onto the wand. Store one accessory on top holder and one accessory on bottom holder.

USING THE MOTORIZED FLOOR NOZZLE

⚠ WARNING: This vacuum does not stand up on its own, so when taking a break from cleaning, rest it against a piece of furniture or a wall, or lay it flat on the floor. Using for an application where the unit lacks stability may result in personal injury.

👉 NOTE: Before vacuuming your delicate area rugs or carpet, refer to the manufacturer's recommended cleaning instructions.

WHAT DOES THE BRUSHROLL INDICATOR LIGHT MEAN?

Solid Green

The brushroll is on and working as it should.

Solid Red

There is a jam in the brushroll area. Turn your vacuum off and remove the blockage.

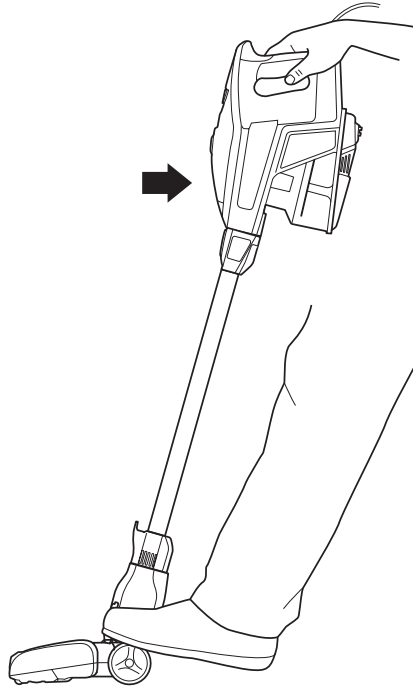

- 1** Plug the unit in and recline the wand.

CHOOSING THE APPROPRIATE SETTING

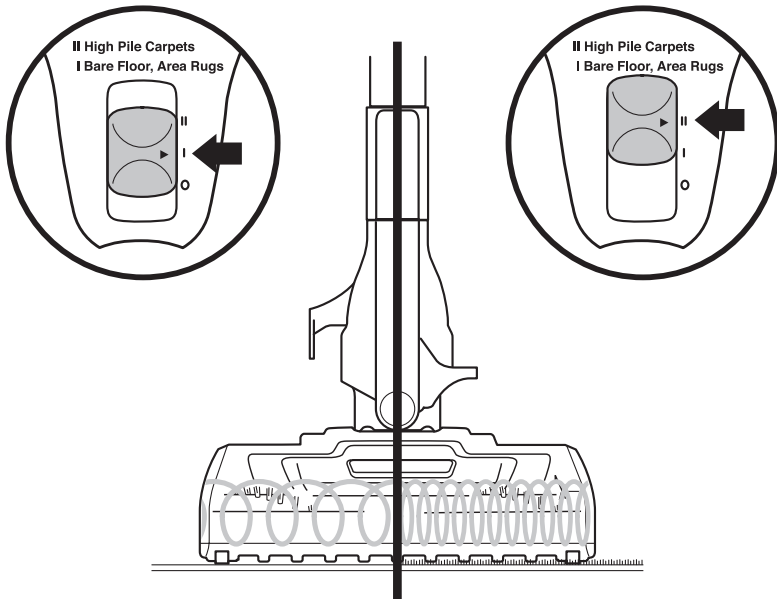

The Rocket® Ultra-Light has a 2-speed Power slider switch on the handle. Slide the Power switch to appropriate speed setting (I or II) and start cleaning.

Bare Floor, Area Rugs (I) – The brushroll spins slowly to clean bare floors and delicate area rugs.

High Pile Carpets (II) – The brushroll spins faster to pick up debris below the surface of your carpets.

NOTE: For deep cleaning per ASTM F 608 (embedded dirt in carpets) please set to High Pile Carpets (II).

USING THE DUST-AWAY™ HARD FLOOR ATTACHMENT

★ **IMPORTANT:** Do not use the Dust-Away Hard Floor Attachment without the Microfiber Pad.

✍️ **NOTE:** Both power settings provide the same suction power.

💡 **TIP:** You can attach the handheld vacuum directly to the motorized floor nozzle for convenient stair cleaning.

MICROFIBER PAD CARE

Machine or hand wash the pads separately in warm water with liquid detergent.

Do not use bleach or fabric softeners as they may damage the pads or leave a coating that will reduce their cleaning performance.

Tumble dry low or line dry to extend the life of the microfiber fabric.

For the best results, replace your microfiber pads every 3 to 4 months.

STEP 1

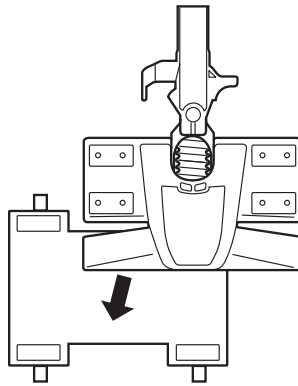

1 Slip two tabs between the nozzle and the duster base and attach them to the front fasteners.

STEP 2

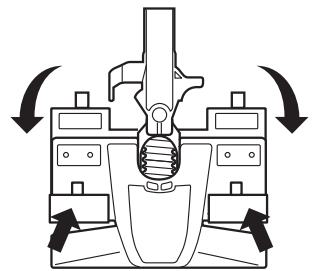

2 Pull the other two tabs tightly around to the back fasteners. Ensure the pad is flat against the bottom surface and tightly secured. Slide the power switch to either setting to clean hard floors. Do not use to clean damp floors or wet/sticky messes. Use only pads provided by Shark.

USING YOUR VACUUM IN ABOVE-FLOOR MODE

STEP 1



STEP 2

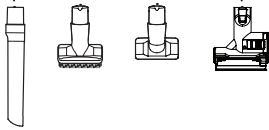

STEP 1

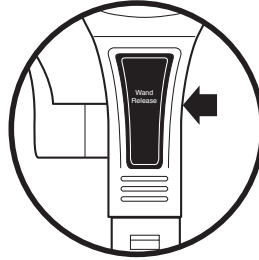

STEP 2

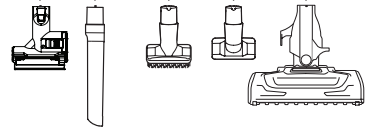

FOR LONG-REACH CLEANING

- 1** Stand the vacuum upright. Step on the foot pedal and pull the wand up to disconnect it from the motorized floor nozzle.
- 2** Attach desired cleaning accessory.

FOR SHORT-REACH CLEANING

- 1** Press the Wand Release button on the top of the wand to disconnect it from the handheld vacuum.
- 2** Attach desired cleaning accessory. The LED light on the handheld vacuum turns on automatically when the power is on.

STORAGE

TIP: If your unit came with an accessory bag, you can hang the bag on the wall mount with the vacuum.

TIP: Be sure to use the plastic anchors provided when mounting into drywall; alternatively you may place screws directly into a stud.

OPTION 1

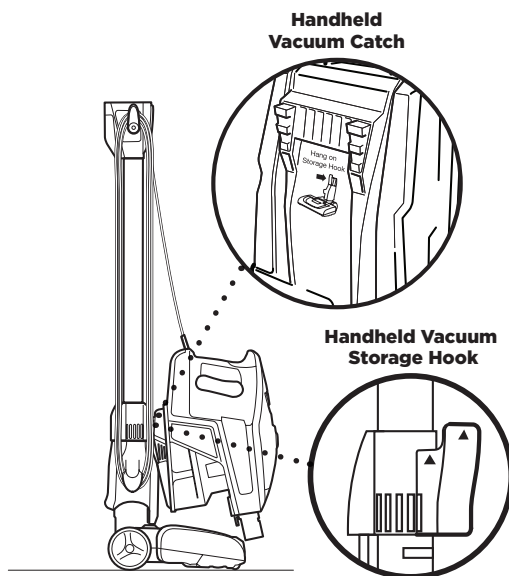

- 1 Press the Wand Release button on the top of the wand to release the handheld vacuum. There is a catch on the bottom of the handheld vacuum. Hang it from the hook located on the bottom portion of the wand. Wrap the cord around the two cord hooks.

OPTION 2

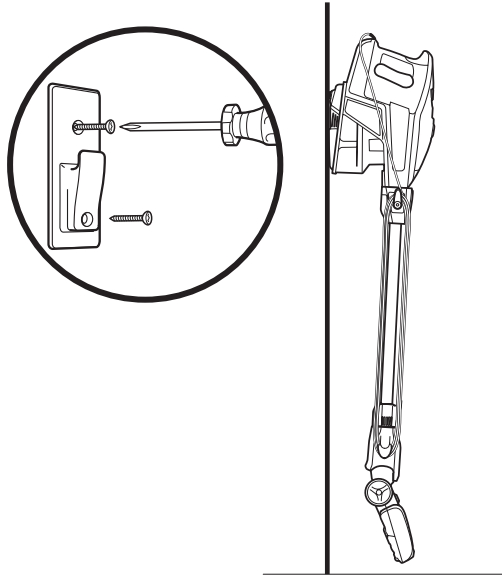

- 2** Use the wall mount that is included. Drill two 5/16" holes and insert plastic anchors provided into the wall. Using a Philips head screwdriver, screw the wall mount into the plastic anchors. Hook the catch on the bottom of the handheld vacuum onto wall mount.

ACCESSORIES

The top flap of your box shows the select accessories that are included with your model.

A 12" Crevice Tool

Clean in between tight spaces or reach baseboards and ceilings with this slim crevice tool.

B Pet/Upholstery Tool

Perfect for grabbing pet hair and lint from furniture and other upholstered surfaces.

C Mini Motorized Brush

The power of a full-size upright in the palm of your hand. Picks up pet hair and loose debris and powerfully cleans dander out of upholstery and surfaces. Cannot be used with the Flexible Hose.

D Dusting Brush

Dust a multitude of surfaces such as shelves, baseboards, window/door frames, and much more. Turn the brush head to adjust the angle to the surface you're cleaning.

E Dust-Away™ Hard Floor Attachment with Microfiber Pad

Direct suction for big crumbs and debris while microfiber pad dusts hardwood and tile floors.

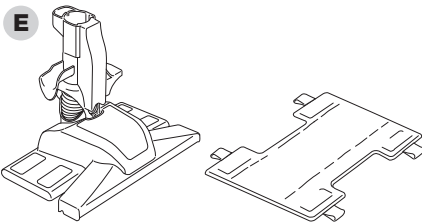
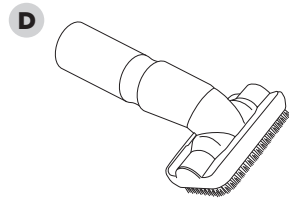
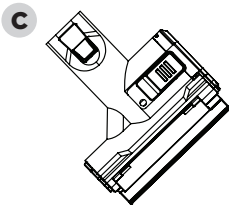
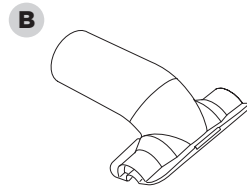
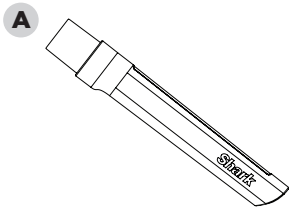

MAINTAINING YOUR VACUUM

⚠ WARNING: Hand wash filters with water only to prevent damage from cleaning chemicals. Allow ALL filters to dry completely before replacing in the vacuum to prevent liquid from being drawn into electric parts.

⚠ CAUTION: Turn power off and unplug before servicing.

★ IMPORTANT: Clean the dust screen inside the dust cup as required.

🖐 NOTE: Empty dust cup when debris reaches the MAX fill line.

RECOMMENDED FILTER CLEANING SCHEDULE:

Pre-Motor Filter Kit

(Foam & Felt)
1080FTV320
Clean once a month.

Post-Motor Filter

1084FTV320
Clean once a year.

STEP 1

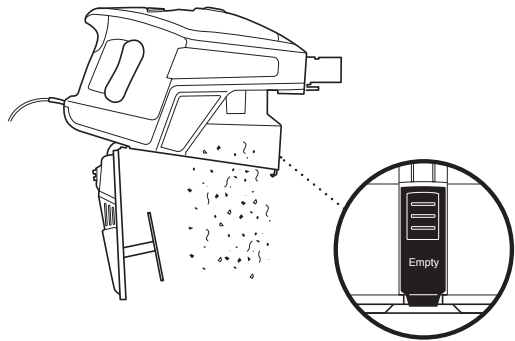
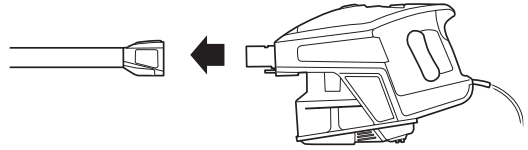

EMPTYING THE DUST CUP

- 1 Press the Wand Release button on the top of the wand to disconnect it from the handheld vacuum.

OR

Remove the dust cup from the handheld vacuum by squeezing the two Dust Cup Release buttons on both sides of the base at the same time and pulling it out.

STEP 2

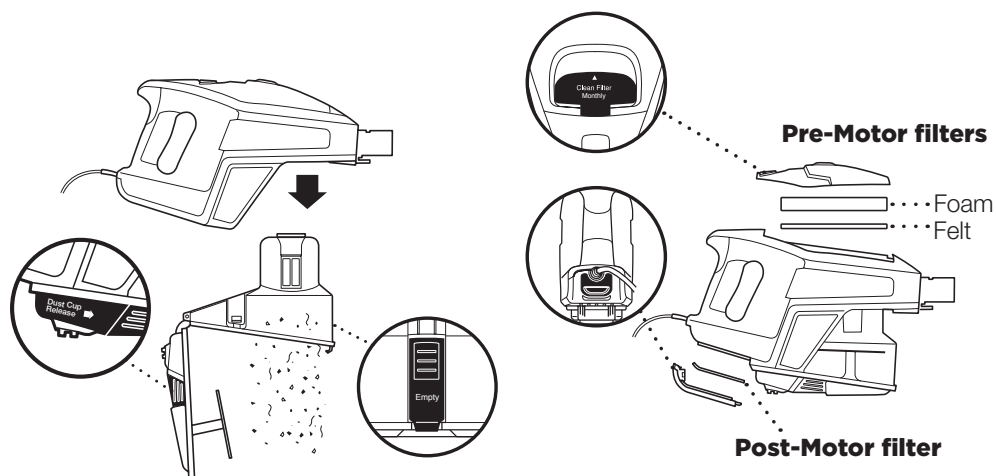

- 2** Hold dust cup over a trash bin and press the Empty button on the front of the dust cup. The bottom lid will open, allowing the debris to fall out.
- 3** Once dust cup is empty, close the bottom lid and insert dust cup back into handheld vacuum until you hear it click into place.

CLEANING THE FILTERS

- 1** Access the Pre-Motor foam and felt filters by lifting the latch on the top of the handheld vacuum. Remove and rinse the filters with water. Tap loose dirt off filters between washes as needed. Once completely dry, insert the felt filter first, then place the foam filter on top of it.
- 2** Access the Post-Motor filter under the handle. Remove and rinse the filter with water.

MAINTAINING YOUR VACUUM

⚠ WARNING: Do not cut anything but the hair, fibers or string that is on the brushroll.

💡 TIP: Ensure the bottom of the floor nozzle is completely sealed and locked before using.

💡 TIP: You do not need any tools to open the floor nozzle—just a coin.

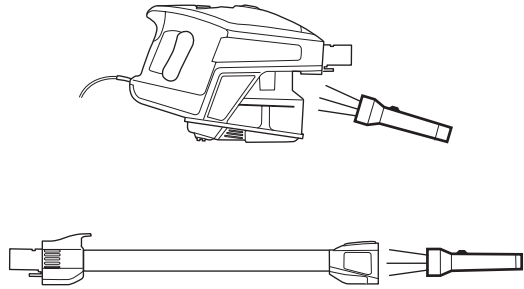

CHECKING FOR BLOCKAGES: HANDHELD AND WAND

- 1** Remove the wand from the handheld portion and check all dust cup intake openings.
- 2** Remove the floor nozzle from the wand and check the wand for blockages.

STEP 1

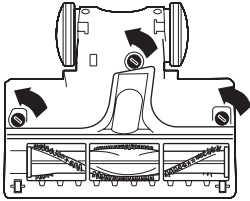

STEP 3

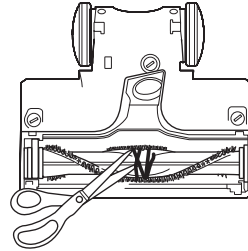

STEP 2

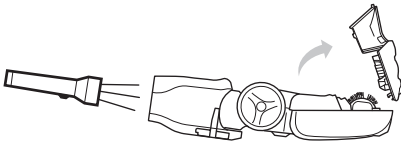

STEP 4

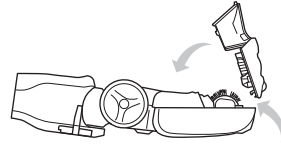

BOTTOM OF FLOOR NOZZLE

- 1** Use a coin to unlock the three locks on the bottom of the floor nozzle.
- 2** A portion of the base is removable to allow for better access to the brushroll and exposure to the airway. Shine a flashlight from the bottom to check for possible blockages in the airway.
- 3** Remove any string, carpet fibers, or hair that may be wrapped around the brushroll. There is a groove along the brushroll that allows a pair of scissors to cut across it to loosen up debris.
- 4** To re-assemble, replace base by lining it up along the front of the nozzle. Push down to snap into place until you hear a click. Lock the three locks.

TROUBLESHOOTING GUIDE

⚠ WARNING: To reduce the risk of shock and unintended operation, turn power off and unplug unit before servicing.

Vacuum is not picking up debris. No suction or light suction.
(Refer to Maintenance section for more information.)

- Check filters to see if they need cleaning. Follow instructions for rinsing and completely air-drying the filters before reinserting in the vacuum.
- Dust cup may be full; empty dust cup.
- Check floor nozzle for blockages; clear blockages if required.
- Remove any string, carpet fibers, or hair that may be wrapped around the brushroll.

Vacuum lifts area rugs.

- Suction is powerful. Take care when vacuuming area rugs or rugs with delicately sewn edges.
- Turn off the unit to disengage the brushroll and restart with the Power slider switch.

Brushroll does not spin.

- If Brushroll Indicator Light on the floor nozzle turns red, the brushroll has stopped spinning. Immediately turn off and unplug vacuum and remove blockage. Re-plug the unit into an electrical outlet and turn vacuum on.
- If Brushroll Indicator Light on the floor nozzle is green, the blockage has been successfully cleared. If the light is still red, please contact customer service at 1-800-798-7398.

Vacuum turns off on its own.

This vacuum is equipped with a motor-protective thermostat so the vacuum will shut off if it overheats. Should this occur, perform the following steps to restart the motor-protective thermostat:

1. Turn vacuum off and unplug it.
2. Empty dust cup and clean filters (see Maintenance section).
3. Check for blockages in hose, accessories, and inlet openings.
4. Allow unit to cool for a minimum of 45 minutes.
5. Plug in vacuum and turn it on.

Shark NINJA FIVE (5) YEAR LIMITED WARRANTY

The 5-Year Limited Warranty applies to purchases made from authorized retailers of **SharkNinja Operating LLC**. Warranty coverage applies to the original owner and to the original product only and is not transferable.

SharkNinja warrants that the unit shall be free from defects in material and workmanship for a period of 5 years from the date of purchase when it is used under normal household conditions and maintained according to the requirements outlined in this instruction manual, subject to the following conditions and exclusions.

What is covered in my warranty?

1. The original unit and/or non-wearable components deemed defective, in SharkNinja's sole discretion, will be repaired or replaced for up to 5 years from the original purchase date.
2. In the rare event that a replacement unit is issued, the warranty coverage ends six months following the receipt date of the replacement unit or the remainder of the existing warranty, whichever is greater. If the unit is replaced, SharkNinja reserves the right to replace the unit with one of equal or greater value.

What is not covered in my warranty?

Our Customer Care/Product Specialists are available to provide all the warranty service options available to you including the possibility of upgrading to our VIP Warranty Service Options for select product categories.

1. Normal wear and tear of wearable parts such as foam filters, HEPA filters, pads etc., which require regular maintenance and/or replacement to ensure the proper functioning of your unit are not covered by this warranty.
2. Any unit that has been tampered with or used for commercial purposes.
3. SharkNinja will cover the cost for the customer to send in the unit to us for repair or replacement. A fee of \$19.95 for return shipping costs will be charged at the time of return shipment of the repaired or replacement unit.
4. Damage caused by misuse, abuse, or negligent handling, or damage due to mishandling in transit.
5. Consequential and incidental damages.
6. Defects caused by or resulting from damages from shipping or from repairs, service, or alteration to the product or any of its parts which have been performed by a repair person not authorized by SharkNinja.
7. Products purchased, used or operated outside of North America.

Problems with your unit/How to get service

If your appliance fails to operate properly while in use under normal household conditions within the warranty period, visit sharkclean.com for product care/maintenance self-help. Our customer care and product specialists are also available at 1-800-798-7398 to assist with product support and warranty service options.

How to initiate a warranty claim

You must first activate your warranty by registering your unit online at sharkclean.com/customersupport. (Note: Purchases made directly from SharkNinja are automatically registered with us and the warranty activated.) Alternatively you can call 1-800-798-7398 to have a customer care specialist assist you. Please note you must call 1-800-798-7398 to initiate a warranty claim. Return and Packing Instruction information will be provided at that time.

The customer care line is open Monday-Saturday, 7am-11pm ET and Sunday, 9am-8pm ET.

Replacement parts are available for purchase at sharkclean.com. For more information on what is classified as wearable and non-wearable parts, please visit sharkwarranty.com.

This warranty gives you specific legal rights, and you also may have other rights that vary from state to state.

Some states do not permit the exclusion or limitation of incidental or consequential damages, so the above may not apply to you.



SharkNinja Operating LLC
US: Newton, MA 02459
CAN: Ville St-Laurent, QC H4S 1A7
1-800-798-7398
sharkclean.com

Illustrations may differ from actual product. We are constantly striving to improve our products; therefore the specifications contained herein are subject to change without notice.

Shark and Rocket are registered trademarks of SharkNinja Operating LLC.

Dust-Away is a trademark of SharkNinja Operating LLC.

For SharkNinja U.S. Patent information, visit sharkninja.com/USPatents

