

Please be sure to read the enclosed Shark® Owner's Guide prior to using your unit.

Shark® Rocket™

ULTRA-LIGHT
WITH DUOCLEAN®

QUICK START GUIDE

WHAT'S INSIDE

- A Handheld Vacuum
- B Motorized Floor Nozzle
- C Wand
- D Duster Crevice Tool

ASSEMBLY

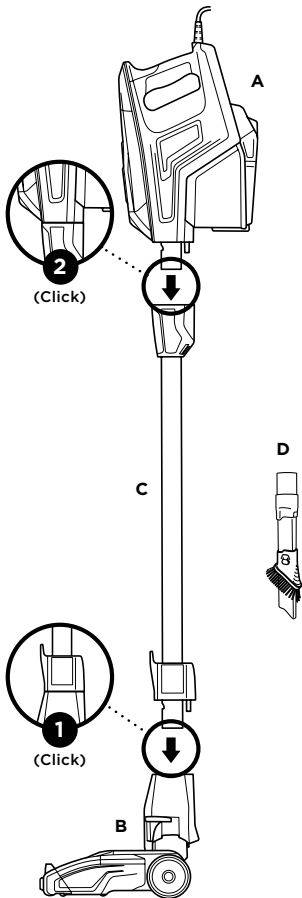

STORAGE

Option 1: Onboard Hook

For compact, convenient storage, hang the handheld vacuum on the hook on the bottom of the wand, and wrap the power cord around the cord hooks. The unit stores easily in a closet or along a wall.

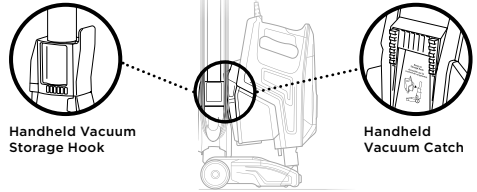

MAINTENANCE

Empty the dust cup every time debris reaches the MAX fill line.

TIP: Wash filters every month to keep the suction strong.

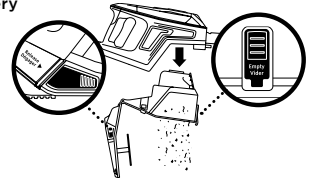

Brushroll Maintenance

1. Press down on the two buttons on the floor nozzle to pop up the brushroll garage lid.

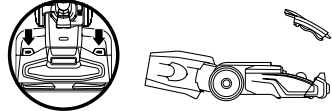

2. Lift the brushroll out by the tab on the left side. Use a pair of scissors to carefully remove any string, hair or debris that may be wrapped around the brushroll.

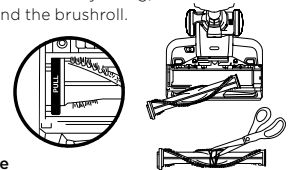

Soft Roller Maintenance

1. Slide the Soft Roller access button up to remove the Soft Roller.

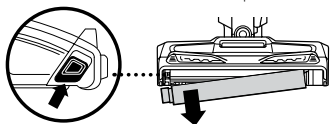

VERSATILE FLOOR-TO-CEILING CLEANING

FLOOR CLEANING

- 1 Plug In Vacuum**
Then place your foot gently on the floor nozzle and tilt the handle back.

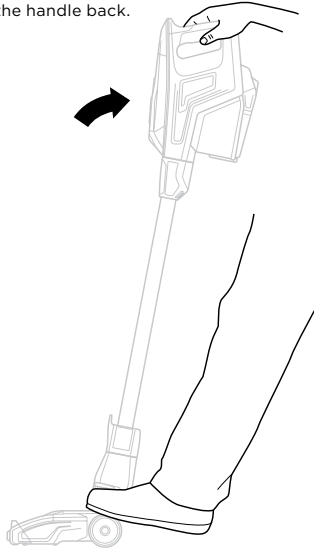

- 2 Choose Setting**
Slide the power switch on the handle to the appropriate floor setting and start cleaning.



Setting I
Gentle on bare floors and area rugs.
The brushroll and the Soft Roller both spin together slowly to clean bare floors and area rugs.



Setting II
Deep-cleans carpets by removing embedded dirt.
Both brushrolls spin faster to pick up debris below the surface of your carpets.



NOTE: For deep cleaning per ASTM F 608 (embedded dirt in carpet) please use Setting II, high pile carpet mode.

ABOVE-FLOOR CLEANING

- 1** Stand the vacuum upright. Step on the foot pedal and pull the wand up to disconnect it from the motorized floor nozzle.

OR

Press the Wand Release button on the top of the wand to disconnect it from the handheld vacuum.



Wand Release



Floor Nozzle Release

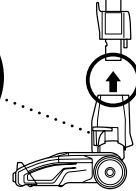

- 2** Attach desired cleaning accessory.

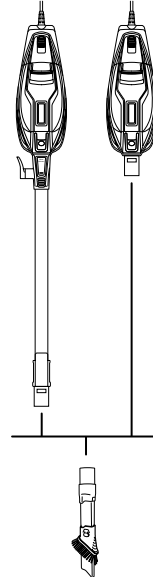

NOTE: Use Setting I for all above-floor accessories.

For questions or to register your product visit us online at sharkclean.com



@sharkcleaning