

Please be sure to read the enclosed Shark® Owner's Guide prior to using your unit.

Shark® ROTATOR® LIFT-AWAY® PROFESSIONAL

QUICK START GUIDE

WHAT'S INSIDE

- A Handle
- B Hose
- C Wand
- D Vacuum Pod
- E Motorized Floor Nozzle
- F 12" Crevice Tool
- G Dusting Brush

ASSEMBLY

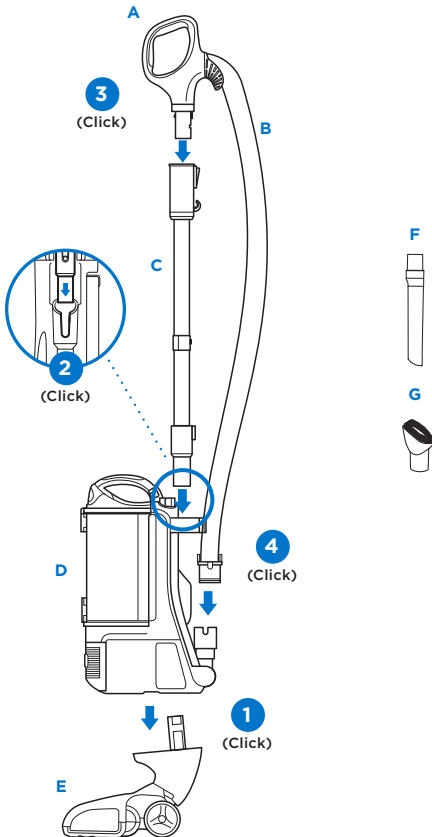

ATTACH ONBOARD ACCESSORIES

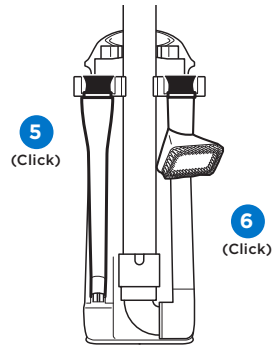

MAINTENANCE

Empty the dust cup after each use.

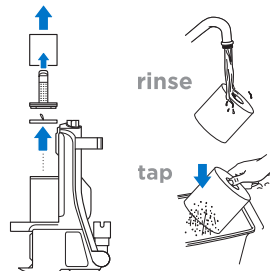
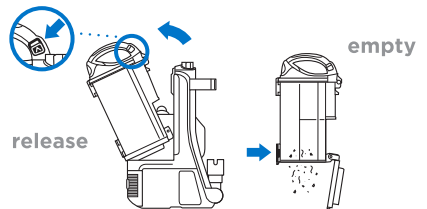

TIP: Wash foam and felt filters every 3 months.

Rinse with water only and allow to air-dry completely before reinstalling. Tap loose dirt from filters as needed between washes.

Note: The foam filter may discolor over time. This is normal.

2 WAYS TO CLEAN

UPRIGHT

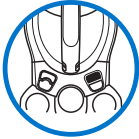

POWER
For cleaning bare floors
or with accessories.

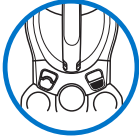

BRUSHROLL
For carpet cleaning
with brushroll

To activate brushroll,
step on floor nozzle
and tilt handle back.

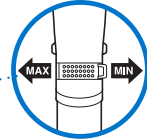
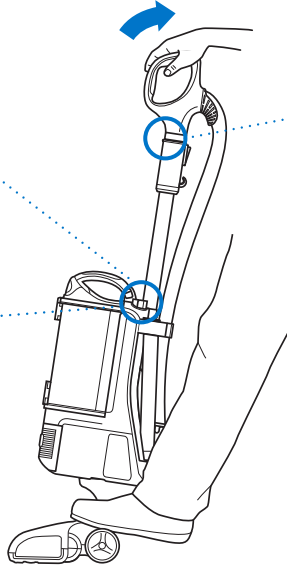

Suction Control
Slide to MIN for more
maneuverability on carpets.
Slide to MAX for more
suction on bare floors.

LIFT-AWAY®

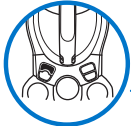

**Lift-Away
Release**

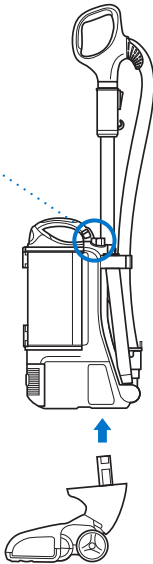

Handle Release

OR



Wand Release

Attach any of the
accessories to handle
or wand

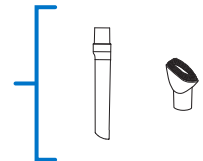

For additional parts and accessories,
visit sharkaccessories.com

For questions or to register your product, visit us online at sharkclean.com