

Please be sure to read the enclosed Shark® Owner's Guide prior to using your unit.

Shark ROTATOR®

SPEED
POWERED
LIFT-AWAY™

QUICK START GUIDE

WHAT'S INSIDE

- A** Vacuum Pod
- B** Motorized Floor Nozzle
- C** Handle & Hose
- D** Wand
- E** Pet Multi-Tool
- F** Duster Crevice Tool
- G** Dust-Away™ Hard Floor Attachment
- H** Home & Car Detail Kit
- I** Canister Caddy

ASSEMBLY

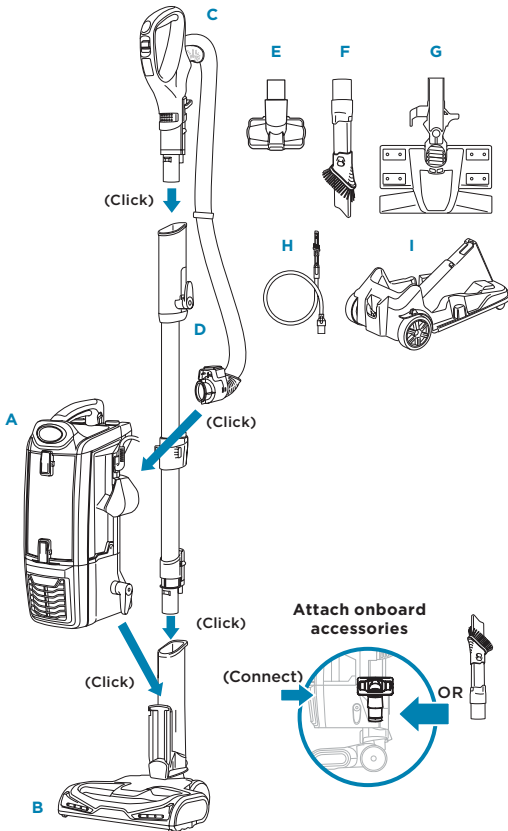

For additional parts and accessories, visit sharkaccessories.com

TIPS

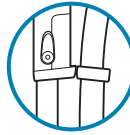

Slide hose clip into back of wand for convenience.

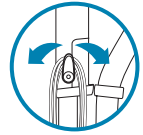

For quick cord access, rotate upper hook down and remove cord.

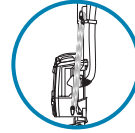

To store your vacuum, wrap cord around cord hooks.

MAINTENANCE

Empty the dust cup after each use.

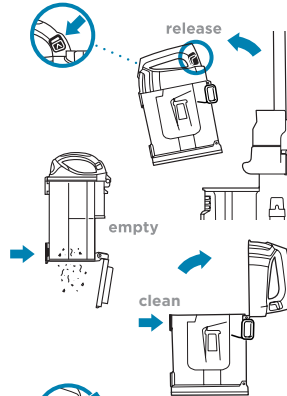

MAINTENANCE: Rinse pre-motor filters every 3 months and HEPA filter once a year. Rinse with water only. Allow filters to air-dry completely before reinstalling.

See enclosed Owner's Guide for more information on how to clean and replace the filters.

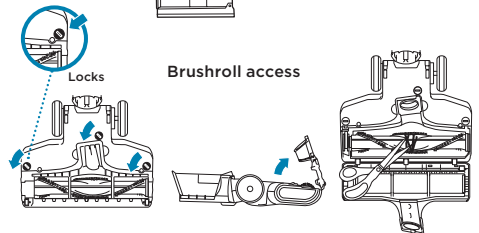

2 WAYS TO CLEAN

UPRIGHT

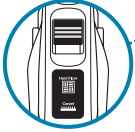

Floor Setting

Slide the Floor Selector up or down to choose Hard Floor or Carpet.

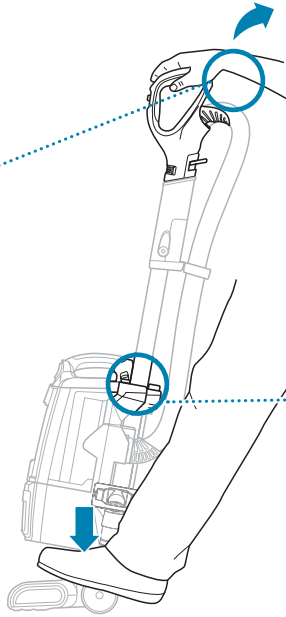

Step on floor nozzle and tilt handle to activate brushroll.

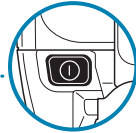

Power

Push the Power button to turn the vacuum on or off.

LIFT-AWAY®

Suction Control

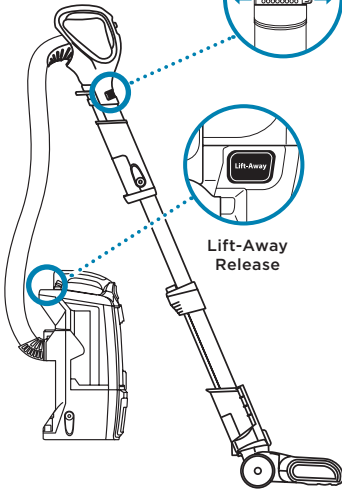
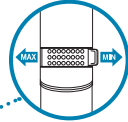

Lift-Away Release

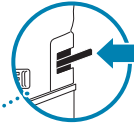

Handle Release

OR



Wand Release

Attach accessories to handle or wand.

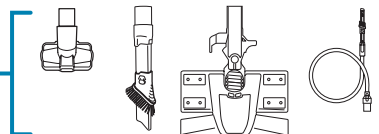

For questions or to register your product, contact us at 1-800-798-7398 or visit us online at sharkclean.com



@sharkcleaning