

VERSATILE CLEANING

FLOOR

Press the Power button, then choose your Surface setting and your Suction setting. Place your foot gently on the floor nozzle and tilt the handle back.

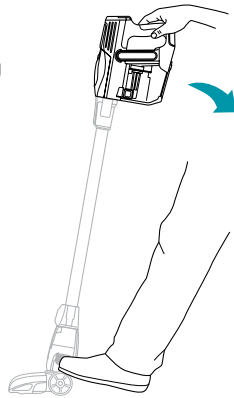

NOTE: Brushroll will only engage when the handle is tilted back.

ABOVE-FLOOR

Stand the vacuum upright. Step on the Floor Nozzle Release button and pull the wand up to disconnect it from the motorized floor nozzle.



Floor Nozzle Release

OR

Press the Wand Release button on the top of the wand to disconnect it from the handheld vacuum.



Wand Release

Attach desired cleaning accessory, then choose your Suction setting.

CONVENIENT STORAGE

Release the handvac and hook onto wand for convenient storage in small spaces.

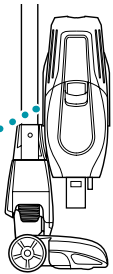
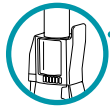

Wall Mount and additional charging options available at sharkaccessories.com.

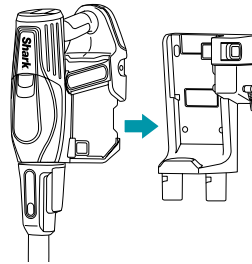

EMPTYING THE DUST CUP

1. To empty dust cup, first remove the handvac from the wand by pressing the Wand Release button and pulling up on the handvac.

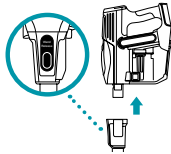

2. Position dust cup over a trash bin, then open the bottom of the dust cup by pressing the Dust Cup Release button on the side.

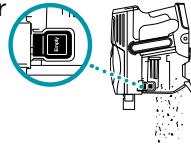

Please make sure to read the enclosed Shark® Owner's Guide prior to using your vacuum.

Shark®

ION Rocket™

CORD-FREE ULTRA-LIGHT

QUICK START GUIDE

Use this Quick Start Guide to learn about your new vacuum's great features.

Register your vacuum at registryourshark.com



Shark



WHAT'S INSIDE:

- A Handheld Vacuum
- B Motorized Floor Nozzle
- C Wand
- D On-Board Storage Hook
- E Pet Multi-Tool
- F 8" Crevice Tool
- G ION Power Pack
- H ION Power Pack Charger

TAKE CHARGE OF YOUR RUNTIME.™

Upgrade to our **2X Ion Power Pack System: second battery + charging dock.**

Available at sharkclean.com/batteries.

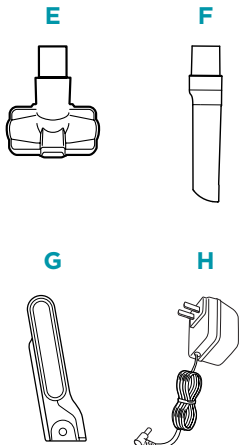

ASSEMBLY

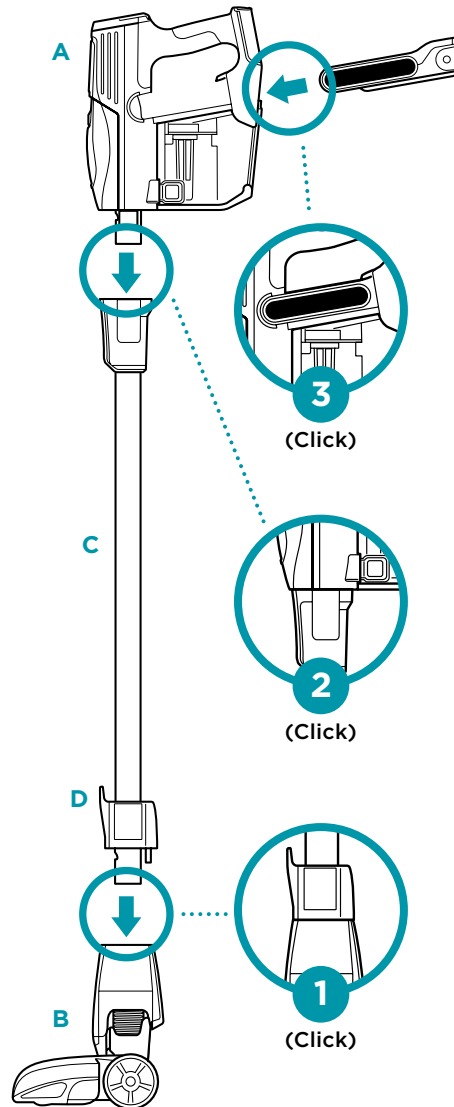

SMART RESPONSE™ TECHNOLOGY

Press the Surface Settings button to switch floor types. Press the Suction Settings button to intelligently switch between EXTEND RUNTIME and MAX POWER.

Surface Settings

- CARPET**
For high pile carpets.
- FLOOR**
For bare floors and area rugs.

Power Button

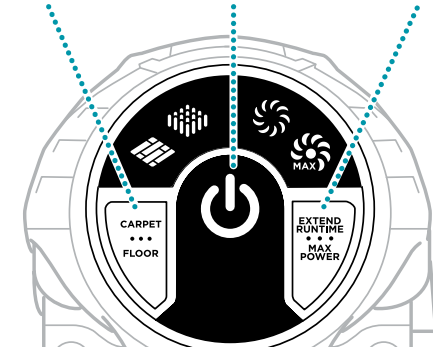

Suction Settings

- EXTEND RUNTIME**
For everyday cleaning.
- MAX POWER**
Maximum power for heavy-duty cleaning.

NOTE: For deep cleaning per ASTM F 608 (embedded dirt in carpets) please select CARPET and MAX POWER settings.

ION POWER PACK

In Use



Charging



NOTE: Full charge takes approximately 3.5 hours.

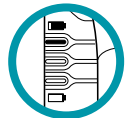

Battery Indicator Lights

NOTE: ION Power Pack comes with a partial charge. Fully charge prior to first use and then completely discharge to condition the pack.

VERSATILE CHARGING

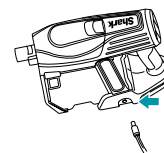

IN THE VACUUM

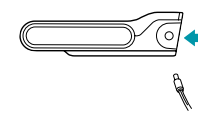

OUT OF THE VACUUM

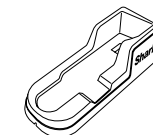

IN AVAILABLE CHARGING DOCK

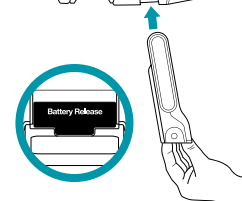
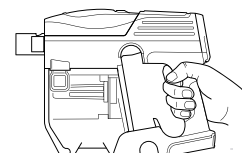

Easily Insert or Remove the ION Power Pack

To insert, slide the ION Power Pack into the slot in the back of the hand vac.

To remove, pinch the release tab then slide out the ION Power Pack.

For complete maintenance instructions, see the enclosed Owner's Guide.

For additional parts and accessories, visit sharkaccessories.com.

For additional batteries and charging accessories, visit sharkclean.com/batteries.