

Please make sure to read the Shark™ Owner's Guide prior to using your fan.

Shark™
Fan Accessories

Clamp Attachment
FA05XCLAMP

⚠ IMPORTANT SAFETY INSTRUCTIONS

READ ALL INSTRUCTIONS BEFORE USE

1. Ensure the clamp is securely fastened to a stable, load-bearing fixture. Tighten both knobs completely to prevent detachment.
2. Verify that the fixture can support the fan's weight before attaching. Do not use on unstable or fragile surfaces.
3. Handle with care. Avoid dropping or exposing the clamp to impacts that could weaken its integrity.
4. Inspect the clamp before each use for signs of wear, cracks, or damage. Replace immediately if deterioration is detected.
5. Keep dry to prevent slippage and ensure a secure hold.
6. Keep out of reach of children.
7. Designed exclusively for FA05X Series. Do not force-fit or modify to accommodate other products.
8. Keep fingers and hands away from the clamping mechanism during use to prevent injury.
9. Avoid using excessive force on the fixture.

Note:

- Center the surface in the clamp before tightening to avoid accidental damage. Fits surfaces up to 1.5" thick.
- Depending on the angle of the fan in the clamp, the misting feature may stop. If you wish to continue misting, change the angle of the fan head on the clamp so that it sits upright.

FA05XCLAMP_QSG_E-F_REV_MV2

US: 1-855-523-4061 | sharkclean.com CA: 1-855-520-7816 | sharkclean.ca

135mm

50mm

50mm

Please make sure to read the Shark™ Owner's Guide prior to using your fan.

Shark™ Fan Accessories

Clamp Attachment FA05XCLAMP

INSTRUCTIONS FOR USE:

1. Turn the large knob counterclockwise to loosen the vise. Place the clamp attachment on a stable fixture, ensuring the bracket sits over it. Tighten by turning the large knob clockwise.
2. Remove the fan head from its base and slide the fan head post into the clamp. Support the fan until the clamp is tightened.
3. Turn the small knob counterclockwise to loosen the ball joint. Adjust the fan head to the desired position, then tighten the ball joint by turning the small knob clockwise.

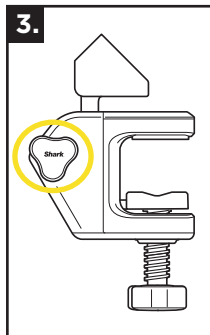
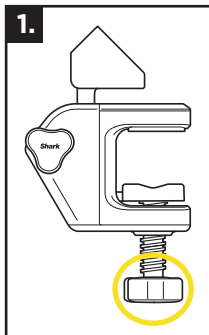

Tips for Usage

Vertical Surfaces

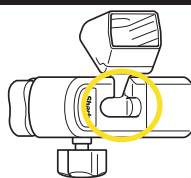

Horizontal Surfaces

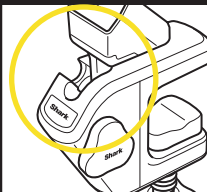

Note: When clamping to a vertical pole, ensure the ball joint notch faces up. This keeps the fan upright, ensuring optimal misting performance.

READ AND SAVE THESE INSTRUCTIONS.

US: 1-855-523-4061 | sharkclean.com CA: 1-855-520-7816 | sharkclean.ca

50mm

50mm

135mm