

# Shark

RV2400WA/RV2400WS Series

## WHAT'S INCLUDED:



Robot

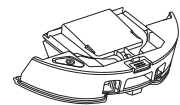

Robot Dust Cup

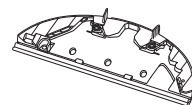

Pad Plate

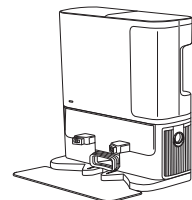

Base



Side Brush  
(Side brush design may vary)



Shark® Cleaner

## LET'S GET CLEANING

Remove all parts and accessories from the box and discard any protective plastic before set-up.

1

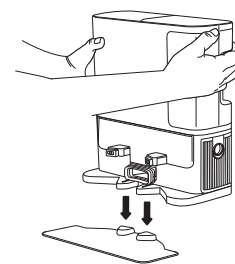

Place the base on mat and plug in.

2

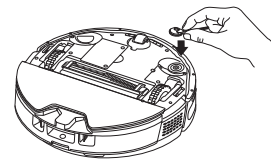

Flip robot over and install side brush by aligning with peg and clicking into place.

3

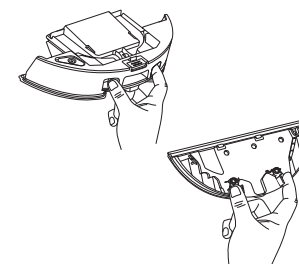

Remove pad plate from robot dust cup.

4

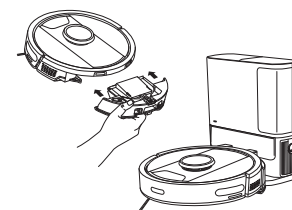

Install dust cup into robot and place on mat, aligning charging contacts on robot and base.

5



Download & Explore the **SharkClean® App**



Let's get cleaning!

FOR ASSISTANCE, PLEASE  
CALL OUR DEDICATED TEAM AT  
**+1-888-668-9600**  
OR SCAN:

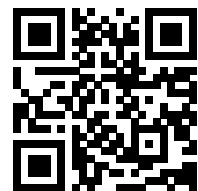

- Getting Started Video
- How-To Videos
- Full Instructions
- Troubleshooting and FAQs
- Maintenance
- Replacement Parts

To learn more about  
your robot visit  
**sharkclean.com/support**

## HELPFUL HINTS

### Base Set-Up

- Place the base on a flat, level **hard floor surface** in a location with a strong Wi-Fi signal.
- Make sure the **base is at least 2 feet away from any carpeted surface**, with at least 2 feet of clearance in front and 1 foot on both sides.
- Plug in the base. The LED will turn green when it is powered on.

### Robot Dust Cup and Pad Plate

Remove pad plate by pinching the 2 blue release buttons and sliding the pad plate off the robot dust cup.



### Robot Install

Orient the robot so its charging contacts align with the base's charging contacts.

### Auto-Evacuation

After 10-15 seconds on the base, your robot will begin to evacuate into the base. This is normal for your self-empty base.

### Wi-Fi Connection

Hold down the  and  buttons on your robot for 5-7 seconds to activate pairing mode.

### Good to Know!

Remove the pad plate on your robot to run a vacuum-only cleaning session. Reattach the pad plate to run a mopping cleaning session.

Flip to learn more. 

## SWITCH BETWEEN MOPPING AND VACUUMING LIKE A PRO

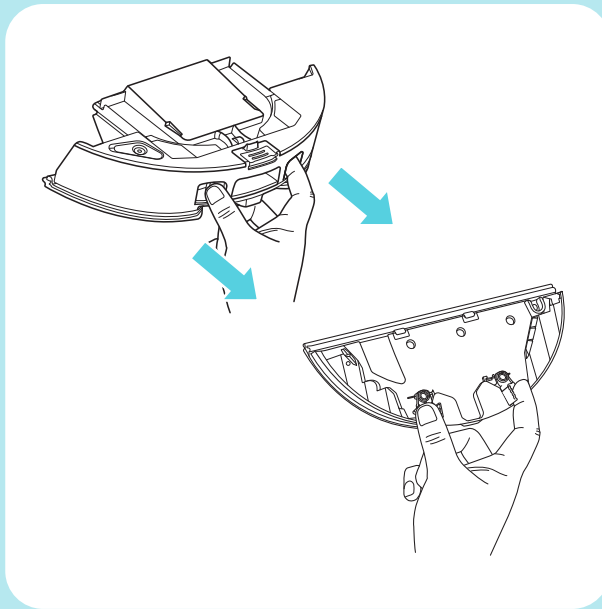

To start vacuum-only cleaning, remove pad plate by pinching **BLUE** release buttons on pad plate and sliding off robot dust bin.

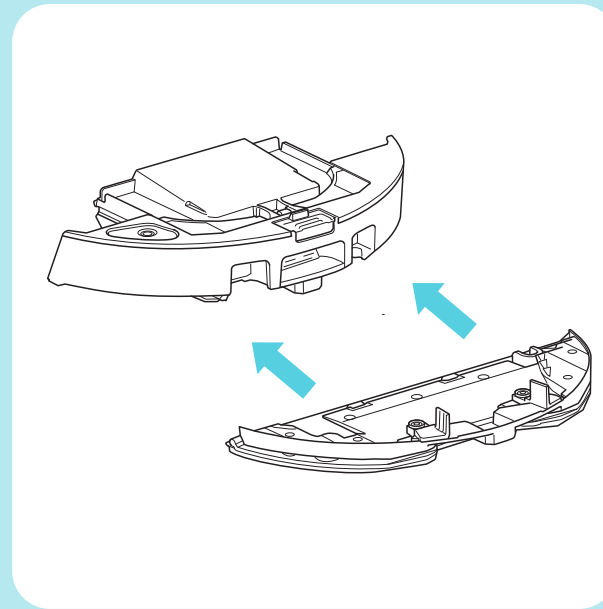

To start mop cleaning, reattach pad plate by sliding onto robot dust bin.



Scan Here for How-To Video