

Shark

RV2600WD Series

WHAT'S INCLUDED:

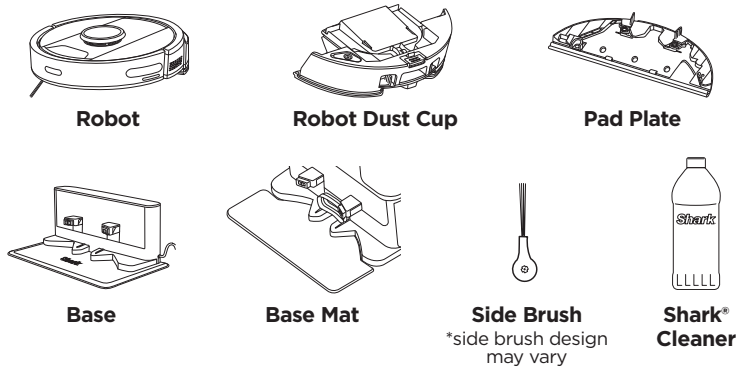

FOR ASSISTANCE, PLEASE CALL OUR DEDICATED TEAM AT **+1-888-668-9600** OR SCAN:



- Getting Started Video
- How-To Videos
- Full Instructions
- Troubleshooting and FAQs
- Maintenance
- Replacement Parts

To learn more about your robot visit
sharkclean.com/support

LET'S GET CLEANING

Remove all parts and accessories from the box and discard any protective plastic before set-up.

1

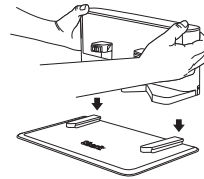

Place the base on mat and plug in

2

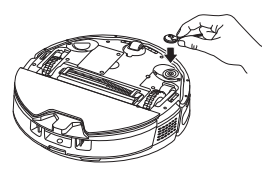

Flip robot over and install side brush by aligning with peg and clicking into place

3

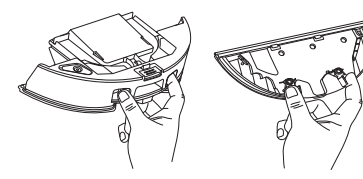

Remove pad plate from robot dust cup

4

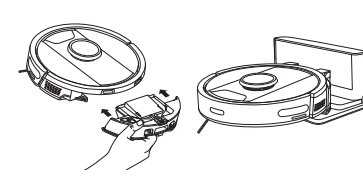

Install dust cup into robot and place on mat, aligning charging contacts on robot and base

5



Download & Explore the SharkClean™ app





Get Cleaning!

HELPFUL HINTS

Base Set-Up

- Place the base on a flat, level **hard floor surface** in a location with a strong Wi-Fi signal.
- Make sure the **base is at least 2 feet away from any carpeted surface**, with at least 2 feet of clearance in front and 1 foot on both sides.
- Plug in the base. The LED will turn green when it is powered on.

Wi-Fi Connection

Hold down the  and  buttons on your robot for 5-7 seconds to activate pairing mode.

Robot Dust Cup and Pad Plate

Remove pad plate by pinching the 2 blue release buttons and sliding the pad plate off the robot dust cup.

Robot Install

Orient the Shark logo **upside-down** and slide the robot onto the charging contacts. The base LED will blink green when the robot is charging.