

Shark

RV2600WA/RV2600WS Series

WHAT'S INCLUDED:

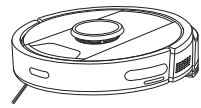

Robot

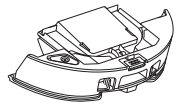

Robot Dust Cup

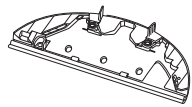

Pad Plate

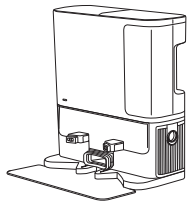

Base



Side Brush
(Side brush design may vary)



Shark® Cleaner

LET'S GET CLEANING

Remove all parts and accessories from the box and discard any protective plastic before set-up.

1

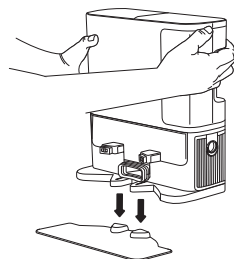

Place the base on mat and plug in.

2

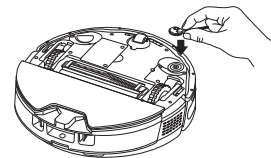

Flip robot over and install side brush by aligning with peg and clicking into place.

3

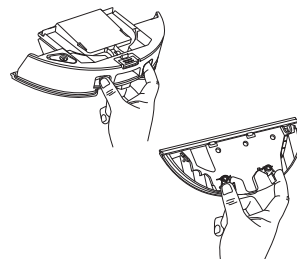

Remove pad plate from robot dust cup.

4

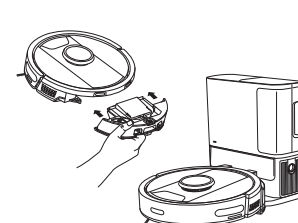

Install dust cup into robot and place on mat, aligning charging contacts on robot and base.

5



Download & Explore the **SharkClean App**



Let's get cleaning!

FOR ASSISTANCE, PLEASE CALL OUR DEDICATED TEAM AT **+1-888-668-9600** OR SCAN:



- Getting Started Video
- How-To Videos
- Full Instructions
- Troubleshooting and FAQs
- Maintenance
- Replacement Parts

To learn more about your robot visit sharkclean.com/support

HELPFUL HINTS

Base Set-Up

- Place the base on a flat, level **hard floor surface** in a location with a strong Wi-Fi signal.
- Make sure the **base is at least 2 feet away from any carpeted surface**, with at least 2 feet of clearance in front and 1 foot on both sides.
- Plug in the base. The LED will turn green when it is powered on.

Robot Dust Cup and Pad Plate

Remove pad plate by pinching the 2 blue release buttons and sliding the pad plate off the robot dust cup.

Robot Install

Orient the robot so its charging contacts align with the base's charging contacts. The base LED will blink green when the robot is charging.

Auto-Evacuation

After 10-15 seconds on the base, your robot will begin to evacuate into the base. This is normal for your self-empty base.

Wi-Fi Connection

Hold down the and buttons on your robot for 5-7 seconds to activate pairing mode.

Good to Know!

Remove the pad plate on your robot to run a vacuum-only cleaning session. Reattach the pad plate to run a mopping cleaning session.

Flip to learn more.

© 2025 SharkNinja Operating LLC. SHARK is a registered trademark of SharkNinja Operating LLC. APPLE, the Apple logo, and iPhone are trademarks of Apple Inc., registered in the U.S. and other countries. APP STORE is a service mark of Apple Inc., registered in the U.S. and other countries. GOOGLE, GOOGLE ASSISTANT, GOOGLE PLAY, the Google Play logo, and Android are trademarks of GOOGLE LLC. RV2600WA_PKG_INSRT_QSG_MP_Mv12

SWITCH BETWEEN MOPPING AND VACUUMING LIKE A PRO

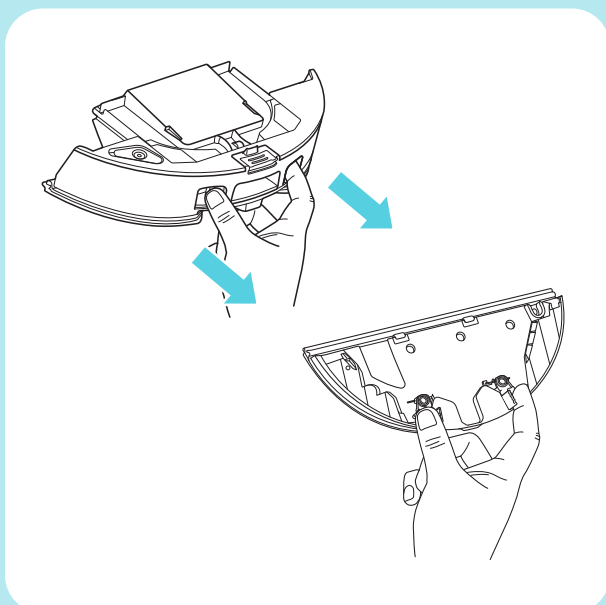

To start vacuum-only cleaning, remove pad plate by pinching **BLUE** release buttons on pad plate and sliding off robot dust bin.

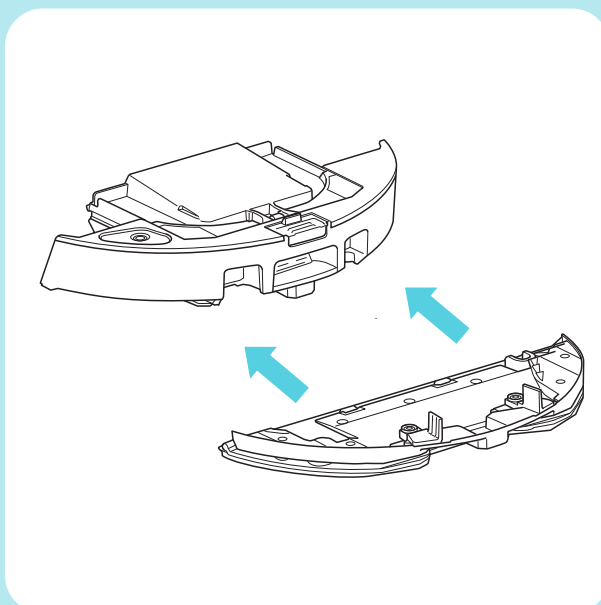

To start mop cleaning, reattach pad plate by sliding onto robot dust bin.



Scan Here for How-To Video