

IMPORTANT SAFETY INSTRUCTIONS

SUITABLE FOR OUTDOOR USE & HOUSEHOLD USE ONLY.

⚠ WARNING

TO REDUCE THE RISK OF FIRE, ELECTRIC SHOCK, OR INJURY: READ ALL THESE INSTRUCTIONS BEFORE USE.

1. This appliance is operated by a rechargeable battery. ONLY recharge the battery with the charger supplied with the unit, battery charger for use only with model GQ36-120300-AUO power supply from Dongguan Gangqi Electronics Co., Ltd. or with model ZD036S120300US from E-TEK or with model AJJ3-1 from Anlian. A charger that may be suitable for one type of battery may create a risk of fire when used with another battery.
2. Do not attempt to destroy, remove, or disassemble the battery pack from the machine. Do not incinerate battery cells. Consult your local waste authority for information regarding available recycling and/or disposal options.
3. This appliance comes with a remote control which contains a coin battery. Dispose of batteries properly. Always keep batteries away from children (choke hazard). Even used batteries can cause injury.
4. To reduce the risk of electric shock, connect only to an outlet provided with a ground fault circuit interrupting (GFCI) device.
5. The fan should be used on a stable and level surface.
6. Never use this fan near pools, bathtubs, showers, basins, or other vessels containing water.
7. Do not operate any unit with a damaged power supply wire or battery charger. Discard the unit or return to an authorized service facility for examination and/or repair.
8. Do not run cord under carpeting. Do not cover charge cord with throw rugs, runners, or similar coverings. Do not route charger cord under furniture or appliances. Keep charger cord away from high-traffic areas. Place charger in an area where the cord will not be tripped over.
9. If the charger cord is damaged, it should be replaced.
10. This appliance is not intended for use by anyone (including children) with reduced physical, sensory, or mental capabilities, or lack of experience and knowledge, unless they have been given supervision or instruction concerning use of the appliance by a person responsible for their safety.
11. Children should be supervised to ensure that they DO NOT play with the appliance.
12. Cleaning and user maintenance shall not be made by children without supervision.
13. Prior to cleaning or other maintenance, the appliance must be unplugged from the electrical outlet.
14. Only use Shark branded accessories.
15. Do not use if appliance is not working as it should, or has been dropped, damaged, left outdoors, or dropped into water.
16. Turn off all controls before plugging in or unplugging the appliance.
17. Unplug from electrical outlet when not in use and before any maintenance or cleaning.
18. Hand wash exterior/hard plastic/non-electronic parts with water only. Do not immerse. Cleaning with chemicals could damage the unit.
19. Do not attempt to repair or adjust any electrical or mechanical functions of this appliance, as this may cause danger and void the warranty.

3. Call a local poison control center for treatment information.
4. Compatible battery type is CR2025.
5. The nominal battery voltage is 3V.
6. Non-rechargeable batteries are not to be recharged.
7. Do not force discharge, recharge, disassemble, heat above (manufacturer's specified temperature rating) or incinerate. Doing so may result in injury due to venting, leakage or explosion resulting in chemical burns.
8. Ensure the batteries are installed correctly according to polarity (+ and -).
9. Do not mix old and new batteries, different brands or types of batteries, such as alkaline, carbon-zinc, or rechargeable batteries.
10. Remove and immediately recycle or dispose of batteries from equipment not used for an extended period of time according to local regulations.
11. Always completely secure the battery compartment. If the battery compartment does not close securely, stop using the product, remove the batteries, and keep them away from children.

⚠ **WARNING: Not suitable for use with solid-state speed controls.**

LITHIUM BATTERY SAFETY WARNINGS

LITHIUM BATTERIES STORE A LARGE AMOUNT OF ENERGY AND WILL VENT FIRE OR EXPLODE IF MISTREATED.

1. DO NOT DO ANY OF THE FOLLOWING TO THE BATTERY PACK:
 - a. Open
 - b. Drop
 - c. Short-circuit
 - d. Puncture
 - e. Incinerate
 - f. Expose to temperatures
2. Keep battery pack dry.
3. Charge battery pack only according to its charger's instructions.
4. Inspect battery pack before every use: do not use or charge if damaged.

BATTERY REMOVAL AND DISPOSAL

This product contains an integral lithium battery (not replaceable), and the remote control uses a lithium coin battery. When the remote battery no longer has a charge, it should be removed from the remote and recycled. DO NOT incinerate or compost the product with its integral battery or the remote battery. When your remote battery needs to be replaced, dispose of it or recycle it in accordance with local ordinances or regulations. In some areas, it is illegal to place spent lithium batteries in the trash or in a municipal solid waste stream. Return spent battery to an authorized recycling center or to retailer for recycling. Contact your local recycling center for information on where to drop off the spent battery.

POWER SUPPLY SAFETY

1. Read and follow all instructions that are on the product or provided with the product.
2. Do not use an extension cord.
3. Do not use within 10 feet of pool and do not use in a bathroom.
4. **WARNING: Risk of Electric Shock.** When used outdoors, install only to a covered Class A GFCI protected receptacle that is weatherproof with the power unit connected to the receptacle. If one is not provided, contact a qualified electrician for proper installation. Ensure that the power unit and cord do not interfere with closing the receptacle cover.

FCC WARNINGS

Note: This equipment has been tested and complies with the limits for a Class B digital device - pursuant to part 15 of the FCC Rules. These limits are designed to provide reasonable protection against harmful interference in a residential installation. This equipment generates, uses, and can radiate radio frequency energy, and if not installed and used in accordance with the instructions, may cause harmful interference to radio communications.

To see if this equipment interferes with radio or television reception, try turning the equipment off and on.

To correct any interference:

- Reorient or relocate the receiving antenna.
- Increase the distance between the equipment and the receiver.
- Connect the equipment to a different outlet than the receiver.
- Consult the dealer or an experienced technician for help.

This device complies with Part 15 of the FCC Rules. Operation is subject to two conditions:

1. This device may not cause harmful interference, and
2. this device must accept any interference received, including interference that may cause undesired operation.

Caution: Any changes or modifications to this unit not expressly approved by the party responsible for compliance could void the user's authority to operate the equipment.

⚠ WARNING

- **INGESTION HAZARD:** This product contains a button cell or coin battery.
- **DEATH** or serious injury can occur if ingested.
- A swallowed button cell or coin battery can cause **Internal Chemical Burns** in as little as **2 hours**.
- **KEEP** new and used batteries **OUT OF REACH OF CHILDREN**.
- **Seek immediate medical attention** if a battery is suspected to be swallowed or inserted inside any part of the body.



1. Remove and immediately recycle or dispose of used batteries according to local regulations and keep away from children. Do NOT dispose of batteries in household trash or incinerate.
2. Even used batteries may cause severe injury or death.

READ AND SAVE THESE INSTRUCTIONS

Please be sure to read and save the warnings on other side prior to using your unit.

QUICK START GUIDE



SETTING UP YOUR FAN

Includes:

- Bolt
- Allen Wrench Multi-Tool
- Charging Cable
- Remote
- Fan Head
- 2-Piece Pole
- Base

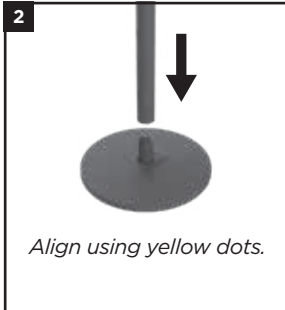
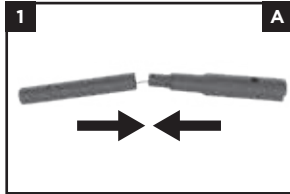

2. Align the yellow dot on the assembled pole with the yellow dot on the **Base**, then slide the pole down onto the base.

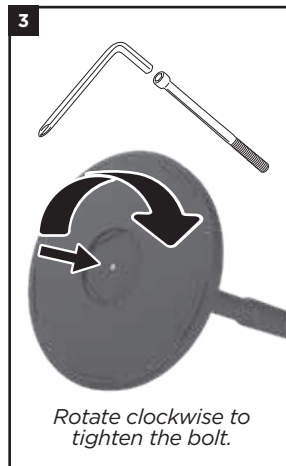

3. Insert the **Bolt** in the bottom of the **Base**. Use the **Allen Wrench** to turn the bolt clockwise to fasten it to the assembled pole.



4. **CAUTION:** finger pinch risk. Holding it by the handle, insert the fan head into the top of the assembled pole until it clicks into place.

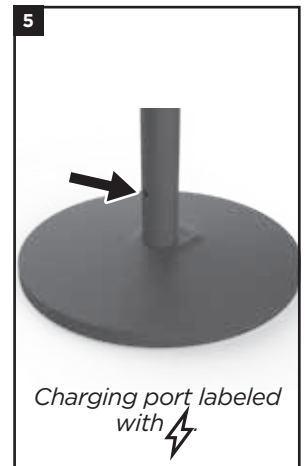

5. **Charge fan to 100% battery** before use without the cord. **First use:** before using remote control, press **Power Button** on fan.

1. Align and insert the **Upper Pole** into the **Lower Pole** until it clicks into place.

FEATURES

CORDLESS

This is a 2-in-1 fan that can be used with or without the cord.

OUTDOORS

This fan can be enjoyed indoors or outdoors.

BOOST MODE

Activate the extra-powerful Boost Mode for maximum-strength air flow.

HOW TO USE YOUR FAN

Fan Speeds	1-3	Press on the fan head or the < > arrows on the remote to switch between fan speeds 1-3. LED lights will indicate selected fan speed.
	Boost Mode	For maximum-strength airflow, press and hold on the fan head for 3 seconds, or press on the remote. During cordless use, fan speed will automatically decrease after 20 minutes to save battery power.
Oscillation Settings	Press on the fan head or < > arrows on the remote to turn 180° oscillation on and off.	
Horizontal Angle Adjust	Press the < > arrows on the remote to change the horizontal angle of the fan at a distance.	
Runtime	MAXIMUM CORDLESS RUNTIME: 20 hours on fan speed 1. MAXIMUM CORDLESS PERFORMANCE: 2 hours on fan speed 3. PLUGGED IN: Indefinite runtime; fan will charge while operating.	
Charge Time	FROM 0% TO FULLY CHARGED BATTERY: 5 hours	
Battery Indicator	100% charged: white light 51%-99%: green light 21%-50%: amber light 6%-20%: red light steady 5% and below: red light blinking	

OSCILLATION & TILT

Enable 180 degrees of horizontal oscillation and up to 55 degrees of vertical tilt.

REMOTE SETTINGS

Store the remote on the back of the fan head when it's not in use.

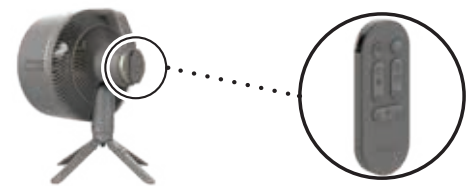

FOR MORE INFORMATION

visit qr.sharkclean.com/fa200series or

SCAN HERE
USING YOUR SMARTPHONE CAMERA



FOR FULL INSTRUCTIONS OR TO PURCHASE ACCESSORIES.

© 2023 SharkNinja Operating LLC. SHARK is a trademark of SharkNinja Operating LLC.

FA200_QSG_WMT_MP_Mv12